

GEORGE W. WATSON III

One Financial Plaza, 14th Floor
Providence, RI 02903-2485
Main (401) 709-3300
Fax (401) 709-3399
gwatson@rc.com
Direct (401) 709-3351

Also admitted in Massachusetts,
Connecticut and Vermont

March 29, 2024

VIA HAND DELIVERY & ELECTRONIC MAIL

Kristen Masse
Coordinator
RI Energy Facility Siting Board
89 Jefferson Boulevard
Warwick, RI 02888

**RE: Docket No. SB-2021-04 – Narragansett Electric Company Aquidneck Island
Gas Reliability Project Old Mill Lane, Portsmouth, Rhode Island
Updated Exhibit List and Copies of New Exhibits**

Dear Kristen:

On behalf of The Narragansett Electric Company (the “Company”), I have enclosed seven copies of an updated Exhibit List along with new exhibits in the above-referenced docket. The new exhibits (TNEC-60 through TNEC-63) are maps from the Company’s consultant, HDR, that reflect the revised layout. TNEC-60 is the current version of the site plan that is under review by the Rhode Island Department of Environmental Management. TNEC-61 is a noise contour map focused on the new vaporizer in the layout currently in use by the Company. TNEC-62 and TNEC-63 are noise contour maps based on the proposed layout.

Thank you for your attention to this matter. If you have any questions, please contact me at (401) 709-3351.

Sincerely,



George W. Watson III

Enclosures

cc: Docket SB-2021-04 Service List

Certificate of Service

I hereby certify that a copy of the cover letter and any materials accompanying this certificate were electronically transmitted to the individuals listed below.

The paper copies of this filing are being hand delivered to the Rhode Island Public Utilities Commission and to the Rhode Island Division of Public Utilities and Carriers.



Heidi J. Seddon

March 29, 2024

Date

SB-2021-04 The Narragansett Electric Company's Application for a License to Mobilize and Operate a Liquefied Natural Gas (LNG) Vaporization Facility at Old Mill Lane (Portsmouth, RI)

Updated February 27, 2024

Name	E-mail
Ronald Gerwatowski (PUC)	Ronald.gerwatowski@puc.ri.gov ;
Terry Gray (DEM)	terry.gray@dem.ri.gov ;
Meredith Brady (DOA)	Meredith.Brady@doa.ri.gov ;
Patricia Lucarelli (PUC)	Patricia.lucarelli@puc.ri.gov ;
Kristen L. Masse (PUC)	Kristen.L.Masse@puc.ri.gov ;
Suzanne Amerault (DEM)	Suzanne.amerault@dem.ri.gov ;
Maria Mignanelli (DOA)	Maria.mignanelli@doa.ri.gov ;
George Watson (Robinson Cole)	gwatson@rc.com ;
Leticia Pimentel (Robinson Cole)	LPimentel@rc.com ;
Steven Boyajian (Robinson Cole)	SBoyajian@rc.com ;
Heidi Seddon	HSeddon@rc.com ;
Ronald Reybitz (PPL)	RJReybitz@pplweb.com ;
Celia O'Brien (PPL)	COBrien@pplweb.com ;
Joanne Scanlon (PPL)	jscanlon@pplweb.com ;
Nicholas Ucci (RIE)	NSUcci@RIEnergy.com ;

Linda George (DPUC)	Linda.George@dpuc.ri.gov ;
Thomas Kogut (DPUC)	thomas.kogut@dpuc.ri.gov ;
Christy Hetherington (DPUC)	christy.hetherington@dpuc.ri.gov ;
John Bell (DPUC)	john.bell@dpuc.ri.gov ;
Margaret Hogan (DPUC)	Margaret.L.Hogan@dpuc.ri.gov ;
Al Mancini (DPUC)	al.mancini@dpuc.ri.gov ;
Paul Roberti (DPUC)	Paul.Roberti@dpuc.ri.gov ;
Ellen Golde (DPUC)	Ellen.Golde@dpuc.ri.gov ;
Todd Bianco (PUC)	Todd.bianco@puc.ri.gov ;
Cynthia Wilson-Frias (PUC)	Cynthia.WilsonFrias@puc.ri.gov ;
John Harrington (PUC)	John.Harrington@puc.ri.gov ;
Alan Nault (PUC)	Alan.Nault@puc.ri.gov ;
Nicholas Vaz (AG)	NVaz@riag.ri.gov ;
Alison Hoffman (AG)	ahoffman@riag.ri.gov ;
Maria Bedell	mbedell@riag.ri.gov ;
James Crowley (CLF)	jcrowley@clf.org ;
David Hill (Energy Futures Group)	dhill@energyfuturesgroup.com ;
Earnest White (Energy Futures Group)	ewhite@energyfuturesgroup.com ;
Jennifer West (Town Clerk, Portsmouth)	clerkoffice@portsmouthri.com ;
Richard Rainer, Jr. (Town Administrator, Portsmouth)	rrainer@portsmouthri.com ;
Kevin Gavin (Town Solicitor, Portsmouth)	kevingavinlaw@gmail.com ;
Wendy Marshall (Town Clerk, Middletown)	wmarshall@middletownri.com ;
Marisa Desautel	Marisa@desautelbrowning.com ;
Terence Tierney	Tierneylaw@yahoo.com ;
Teresa Monterey (Portsmouth Zoning Board)	tmonterey@portsmouthri.com ;
Gareth Eames (Portsmouth Building Official)	geames@portsmouthri.com ;

Charlotte Taylor (RI Historical Preservation and Heritage commission)	Charlotte.Taylor@preservation.ri.gov ;
Elizabeth Totten (RI Historical Preservation and Heritage commission)	elizabeth.totten@preservation.ri.gov ;
Paul Rodrigues (Portsmouth Department of Public Works)	prodrigues@portsmouthri.gov ;
Brian Woodhead (Portsmouth Department of Public Works)	bwoodhead@portsmouthri.gov ;
Jenna Giguere (RI DEM)	Jenna.Giguere@dem.ri.gov ;
Jason McNamee (RI DEM)	Jason.mcnamee@dem.ri.gov ;
Leon Lesinski (Portsmouth Planning Commission)	llesinski@portsmouthri.com ;
Lea Hitchen (Town Planner, Portsmouth)	lhitchen@portsmouthri.gov ;
Roberta Groch (Division of Statewide Planning)	Roberta.Groch@doa.ri.gov ;
Mary Rose Pellegrino (Department of Administration)	maryrose.pellegrino@doa.ri.gov ;
Michael Byrns (RI DOH)	michael.byrns@health.ri.gov ;
Christopher Kearns (OER)	Christopher.Kearns@energy.ri.gov ;
William Owen (OER)	william.owen@energy.ri.gov ;
RI Senator Luis DiPalma	Sen-DiPalma@rilegislature.gov ;
Peter Horvath	Pjh11503@yahoo.com ;
Steven MacDonald	Semacondonald124@outlook.com ;
Laurie MacDonald	Macdonalds6@cox.net ;
Lawrence Silvia	watchesetc@cox.net ;
Ed Sisk	ed@xlnorth.com ;
Jeff Loiter	jeff.loiter@gmail.com ;
Adam Fague (Statewide Planning)	Adam.fague@doa.ri.gov ;

STATE OF RHODE ISLAND
ENERGY FACILITY SITING BOARD

In re: The Narragansett Electric Company :
 Aquidneck Island Gas Reliability Project : Docket No. SB-2021-04
 Portsmouth, Rhode Island :

THE NARRAGANSETT ELECTRIC COMPANY
EXHIBIT LIST

TNEC Exhibit No.	Description	Filed
TNEC-1A	Application for License to Construct and Alter Major Energy Facilities	May 19, 2021
TNEC-1B	Portable LNG Vaporization Project Siting Report	May 19, 2021
TNEC-2	Petition for Waiver Extension	May 19, 2021
TNEC-3	Slide Presentation for Preliminary Hearing	August 12, 2021
TNEC-4	October 1, 2021 Status Report to the EFSB	October 1, 2021
TNEC-5A	Prefiled Testimony of Jacques Afonso	October 1, 2021
TNEC-5B	Prefiled Joint Testimony of Danil Lamriben and Nicholas Dube	October 1, 2021
TNEC-5C	Prefiled Testimony of Tim Casey	October 1, 2021
TNEC-5C (Revision)	Prefiled Testimony of Tim Casey – Revised Page 5	November 18, 2021
TNEC-6	October 15, 2021 Status Report to the EFSB	October 15, 2021
TNEC-7	November 15, 2021 Status Report to the EFSB	November 15, 2021
TNEC-8	Portsmouth GIS Aerial Photo	November 18, 2021
TNEC-9	December 16, 2021 Status Report to the EFSB	December 16, 2021
TNEC-10	January 14, 2022 Status Report to the EFSB	January 14, 2022

TNEC-11	February 15, 2022 Status Report to the EFSB	February 15, 2022
TNEC-12	March 15, 2022 Status Report to the EFSB	March 15, 2022
TNEC-13	AIGRP License Application (Supplemental Application)	April 1, 2022
TNEC-14	AIGRP Siting Report	April 1, 2022
TNEC-14A	AIGRP Siting Report – Replacement Pages (Pages 115-116c)	April 28, 2022
TNEC-14B	AIGRP Siting – Replacement Pages (Page 43, Appendix G)	August 4, 2022
TNEC-15	Petition for Second Waiver Extension	July 11, 2022
TNEC-16	AIGRP Preliminary Hearing – PowerPoint Presentation	July 25, 2022
TNEC-17	Prefiled Testimony of Jeffrey Montigny	September 8, 2023
TNEC-18	Prefiled Testimony of Brian Kirkwood	September 8, 2023
TNEC-19	Prefiled Testimony of Julie Porcaro	September 8, 2023
TNEC-20	Prefiled Testimony of Jacques Afonso	September 8, 2023
TNEC-21	Prefiled Testimony of Timothy Casey	September 8, 2023
TNEC-22	Prefiled Rebuttal Testimony of Jeffrey A. Montigny	November 3, 2023
TNEC-23	Prefiled Rebuttal Testimony of Stuart A. Wilson	November 3, 2023
TNEC-24	Prefiled Rebuttal Testimony of Brett s. Feldman	November 3, 2023
TNEC-25	Prefiled Direct Testimony of Tyler Olney	November 3, 2023
TNEC-26	Prefiled Rebuttal Testimony of Pat Convery	November 3, 2023
TNEC-27	Responses to Acadia’s Data Requests from 11-18-2021 Hearing	January 14, 2022

TNEC-28	Responses to EFSB's Record Requests from 11-18-2021 Hearing	January 14, 2022
TNEC-29	Responses to EFSB's First Set of Data Requests	May 13, 2022
TNEC-30	Supplemental Response to EFSB's Data Request 1-4 – CONFIDENTIAL	June 9, 2022
TNEC-31	Petition for Second Waiver Extension	July 11, 2022
TNEC-32	Responses to EFSB's Record Requests from 07-25-2022 Hearing - CONFIDENTIAL	August 17, 2022
TNEC-33	TNEC's Notice re Temporary Mobilization	September 27, 2022
TNEC-34	Responses to EFSB Set 2 (has confidential component – conf attachments filed separately – no part of a confidential set – <i>please advise</i>)	January 6, 2023
TNEC-35	Motion to Extend Deadline to Submit Advisory Opinion	January 6, 2023
TNEC-36	Responses to Portsmouth Set 1 (Attachments 1-15-2, 1-15-3, 1-15-4 filed in excel format)	March 1, 2023
TNEC-37	Responses to EFSB Set 3	March 14, 2023
TNEC-38	Motion to Extend Deadline to Submit Advisory opinion	May 12, 2023
TNEC-39	Supplement to Motion to Extend Deadline to Submit Advisory Opinion	May 17, 2023
TNEC-40	Notice of Mobilization	September 7, 2023
TNEC-40	Petition for Third Waiver Extension	September 7, 2023
TNEC-41	Notice of Off-Hour Delivery Events	October 3, 3023
TNEC-42	PUC Docket No. 22-42-NG – Company Response to CLF 1-5	February 27, 2024
TNEC-43	PUC Docket No. 22-42-NG – Company Response to Division 1-1	February 27, 2024

TNEC-44	PUC Docket No. 22-42-NG – Company Response to Division 1-2	February 27, 2024
TNEC-45	PUC Docket No. 22-42-NG – Company Response to Division 2-1	February 27, 2024
TNEC-46	PUC Docket No. 22-42-NG – Company Response to Division 4-1	February 27, 2024
TNEC-47	PUC Docket No. 22-42-NG – Company Response to Division 4-3	February 27, 2024
TNEC-48	PUC Docket No. 22-42-NG – Company Response to Division 4-4	February 27, 2024
TNEC-49	PUC Docket No. 22-42-NG – Company Response to PUC 1-9	February 27, 2024
TNEC-50	PUC Docket No. 22-42-NG – Company Response to PUC 1-11	February 27, 2024
TNEC-51	PUC Docket No. 22-42-NG – Company Response to PUC 1-13	February 27, 2024
TNEC-52	PUC Docket No. 22-42-NG – Company Response to PUC 2-1	February 27, 2024
TNEC-53	PUC Docket No. 22-42-NG – Company Response to PUC 3-1	February 27, 2024
TNEC-54	PUC Docket No. 22-42-NG – Company Response to PUC 3-2	February 27, 2024
TNEC-55	PUC Docket No. 22-42-NG – Company Response to PUC 3-3	February 27, 2024
TNEC-56	PUC Docket No. 22-42-NG – Company Response to Middletown 1-4	February 27, 2024
TNEC-57	PUC Docket No. 22-42-NG – Company Response to Middletown 1-5	February 27, 2024
TNEC-58	PUC Docket No. 22-42-NG – Company Response to Middletown 2-4	February 27, 2024
TNEC-59	PUC Docket No. 22-42-NG – Company Response to Middletown 3-1	February 27, 2024
TNEC-60	HDR – Civil Plan Set Dated 01-12-2024	March 29, 2024

TNEC-61	HDR – Operational Noise Contours, Existing Case – Date 7/26/2023	March 29, 2024
TNEC-62	HDR – 500 MSCFH Vaporizer and Pump Trailer Operation- Noise Contour Map – Date 03/28/2023	March 29, 2024
TNEC-63	HDR – Storage Tank Cooldown - Noise Contour Map – Date 06/21/2023	March 29, 2024

Date: March 29, 2024

PLANS FOR
**THE NARRAGANSETT ELECTRIC COMPANY
 AQUIDNECK ISLAND GAS RELIABILITY PROJECT
 OLD MILL LANE, PORTSMOUTH, RI**
CIVIL PLAN SET

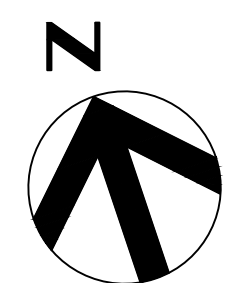

DRAWING INDEX

1 OF 8	G-1	COVER SHEET
2 OF 8	G-2	EXISTING CONDITIONS PLAN
3 OF 8	C-1	PROPOSED SITE LAYOUT PLAN
4 OF 8	C-2	CIVIL DETAILS
5 OF 8	C-3	EROSION & SEDIMENT CONTROL PLAN
6 OF 8	C-4	EROSION & SEDIMENT CONTROL DETAILS
7 OF 8		OLD MILL LANE WETLAND MITIGATION/ENHANCEMENT PLAN
8 OF 8		EXISTING CONDITIONS SURVEY SHOWING LOT 74 BOUNDARY

LOCATION MAP
 SCALE: 1" = 500'

**OLD MILL LANE
 PORTSMOUTH, RHODE ISLAND**
**TOWN OF PORTSMOUTH
 MAP 68 LOT 74**

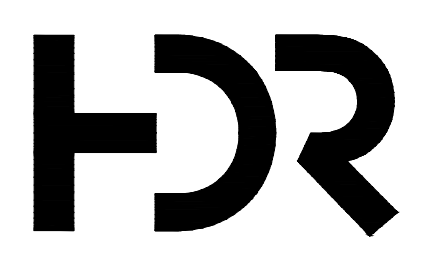

ISSUE	DATE	DESCRIPTION
6	01/12/2024	REVISED CIVIL PLAN SET PER RIDEM COMMENTS
5	11/29/2023	REVISED CIVIL PLAN SET PER RIDEM COMMENTS
4	09/29/2023	REVISED CIVIL PLAN SET FOR NEW LAYOUT
3	05/27/2022	REVISED CIVIL PLAN SET
2	05/05/2022	REVISED CIVIL PLAN SET
1	02/18/2022	CIVIL PLAN SET

PROJECT MANAGER ANKIT DHAR	
DESIGNED BY	B. PAULA
DRAWN BY	W. LIN
CHECKED BY	H. NEENAN
APPROVED BY	A. DHAR
PROJECT NUMBER	10328992

**RHODE ISLAND ENERGY
 AQUIDNECK ISLAND GAS RELIABILITY PROJECT
 OLD MILL LANE, PORTSMOUTH, RI**
 TOWNSHIP OF PORTSMOUTH
 MAP 68, LOT 74

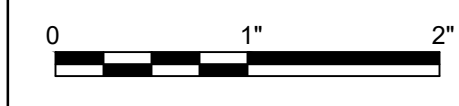

COVER SHEET

FILENAME
 SCALE

SHEET 1 OF 8
 G-1

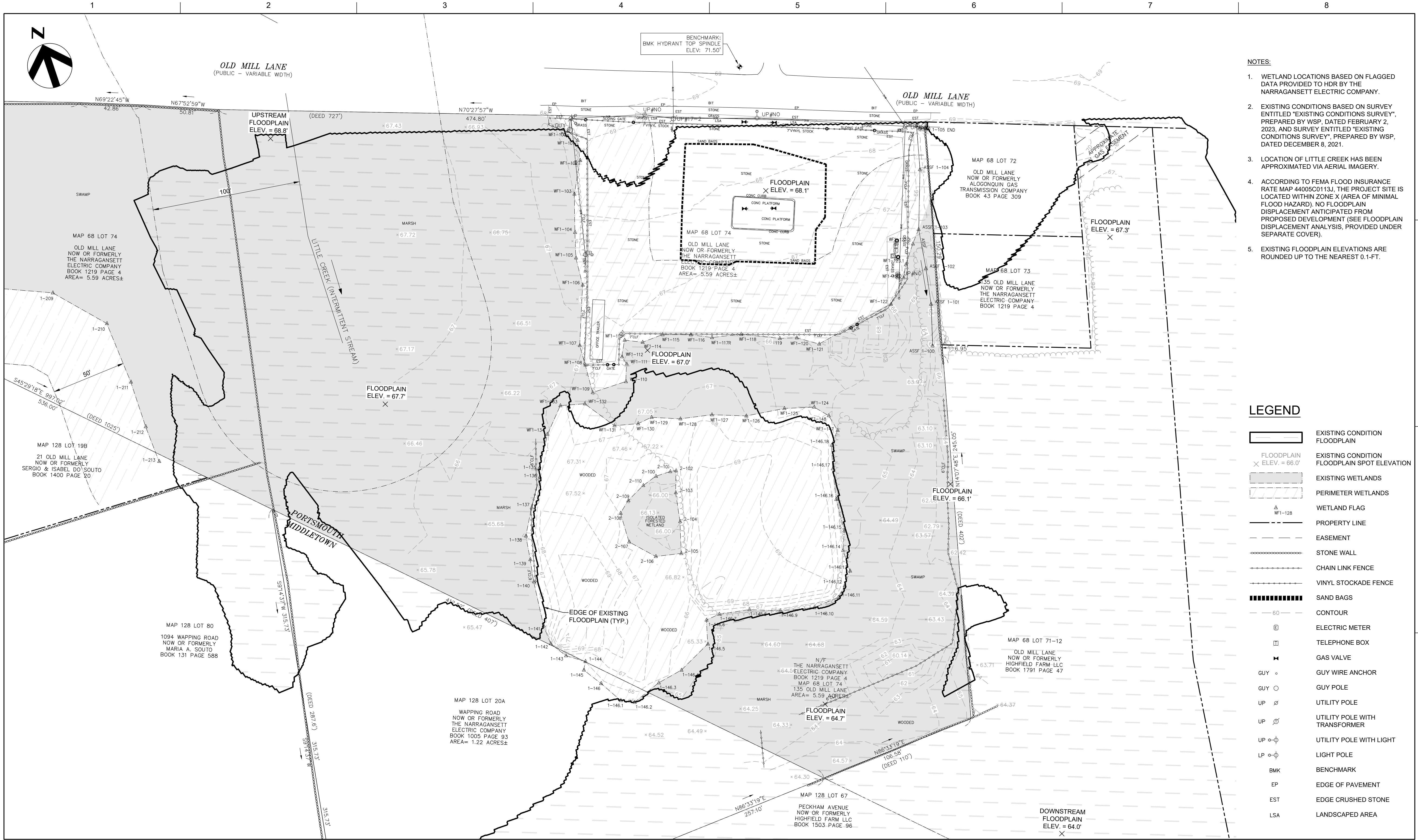

- NOTES:**
1. WETLAND LOCATIONS BASED ON FLAGGED DATA PROVIDED TO HDR BY THE NARRAGANSETT ELECTRIC COMPANY.
 2. EXISTING CONDITIONS BASED ON SURVEY ENTITLED "EXISTING CONDITIONS SURVEY", PREPARED BY WSP, DATED FEBRUARY 2, 2023, AND SURVEY ENTITLED "EXISTING CONDITIONS SURVEY", PREPARED BY WSP, DATED DECEMBER 8, 2021.
 3. LOCATION OF LITTLE CREEK HAS BEEN APPROXIMATED VIA AERIAL IMAGERY.
 4. ACCORDING TO FEMA FLOOD INSURANCE RATE MAP 44005C0113J, THE PROJECT SITE IS LOCATED WITHIN ZONE X (AREA OF MINIMAL FLOOD HAZARD). NO FLOODPLAIN DISPLACEMENT ANTICIPATED FROM PROPOSED DEVELOPMENT (SEE FLOODPLAIN DISPLACEMENT ANALYSIS, PROVIDED UNDER SEPARATE COVER).
 5. EXISTING FLOODPLAIN ELEVATIONS ARE ROUNDED UP TO THE NEAREST 0.1-FT.

LEGEND

- EXISTING CONDITION FLOODPLAIN
- EXISTING CONDITION FLOODPLAIN SPOT ELEVATION
- EXISTING WETLANDS
- PERIMETER WETLANDS
- WETLAND FLAG
- PROPERTY LINE
- EASEMENT
- STONE WALL
- CHAIN LINK FENCE
- VINYL STOCKADE FENCE
- SAND BAGS
- CONTOUR
- ELECTRIC METER
- TELEPHONE BOX
- GAS VALVE
- GUY WIRE ANCHOR
- GUY POLE
- UTILITY POLE
- UTILITY POLE WITH TRANSFORMER
- UTILITY POLE WITH LIGHT
- LIGHT POLE
- BENCHMARK
- EDGE OF PAVEMENT
- EDGE CRUSHED STONE
- LANDSCAPED AREA

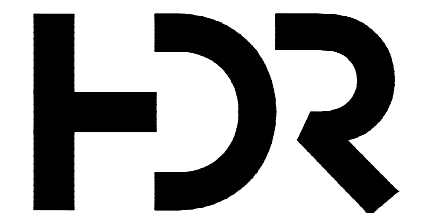

ISSUE	DATE	DESCRIPTION
6	01/12/2024	REVISED CIVIL PLAN SET PER RIDEM COMMENTS
5	11/29/2023	REVISED CIVIL PLAN SET PER RIDEM COMMENTS
4	09/29/2023	REVISED CIVIL PLAN SET FOR NEW LAYOUT
3	05/27/2022	REVISED CIVIL PLAN SET
2	05/05/2022	REVISED CIVIL PLAN SET
1	02/18/2022	CIVIL PLAN SET

PROJECT MANAGER ANKIT DHAR	
DESIGNED BY	B. PAULA
DRAWN BY	W. LIN
CHECKED BY	H. NEENAN
APPROVED BY	A. DHAR
PROJECT NUMBER 10328992	

**RHODE ISLAND ENERGY
AQUIDNECK ISLAND GAS RELIABILITY PROJECT
OLD MILL LANE, PORTSMOUTH, RI**

TOWNSHIP OF PORTSMOUTH
MAP 68, LOT 74



FILENAME
SCALE 1" = 30'

SHEET 2 OF 8
G-2

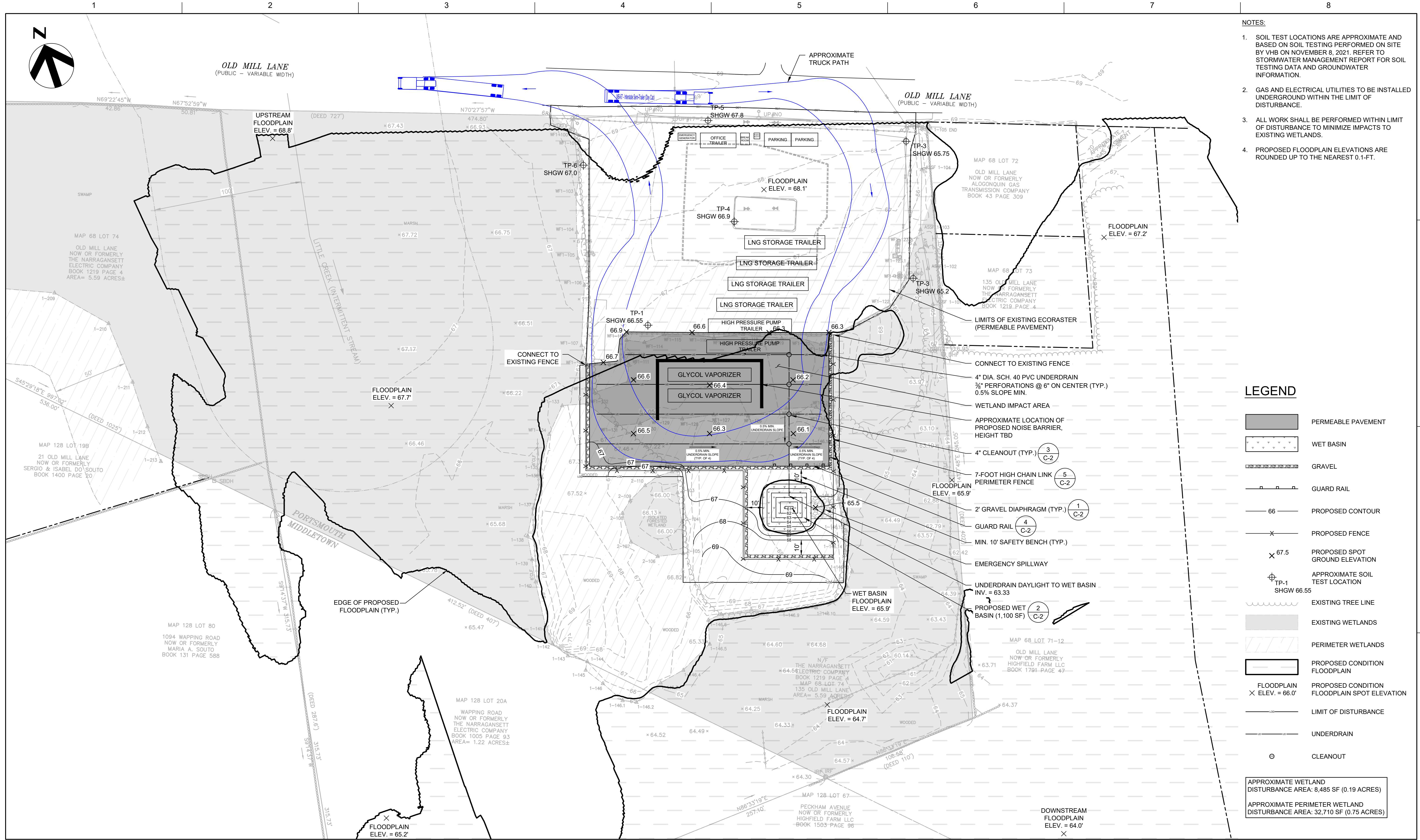

- NOTES:**
1. SOIL TEST LOCATIONS ARE APPROXIMATE AND BASED ON SOIL TESTING PERFORMED ON SITE BY VHB ON NOVEMBER 8, 2021. REFER TO STORMWATER MANAGEMENT REPORT FOR SOIL TESTING DATA AND GROUNDWATER INFORMATION.
 2. GAS AND ELECTRICAL UTILITIES TO BE INSTALLED UNDERGROUND WITHIN THE LIMIT OF DISTURBANCE.
 3. ALL WORK SHALL BE PERFORMED WITHIN LIMIT OF DISTURBANCE TO MINIMIZE IMPACTS TO EXISTING WETLANDS.
 4. PROPOSED FLOODPLAIN ELEVATIONS ARE ROUNDED UP TO THE NEAREST 0.1-FT.

LEGEND

- PERMEABLE PAVEMENT
- WET BASIN
- GRAVEL
- GUARD RAIL
- PROPOSED CONTOUR
- PROPOSED FENCE
- PROPOSED SPOT GROUND ELEVATION
- APPROXIMATE SOIL TEST LOCATION
- EXISTING TREE LINE
- EXISTING WETLANDS
- PERIMETER WETLANDS
- PROPOSED CONDITION FLOODPLAIN
- PROPOSED CONDITION FLOODPLAIN SPOT ELEVATION
- LIMIT OF DISTURBANCE
- UNDERDRAIN
- CLEANOUT

APPROXIMATE WETLAND DISTURBANCE AREA: 8,485 SF (0.19 ACRES)
 APPROXIMATE PERIMETER WETLAND DISTURBANCE AREA: 32,710 SF (0.75 ACRES)

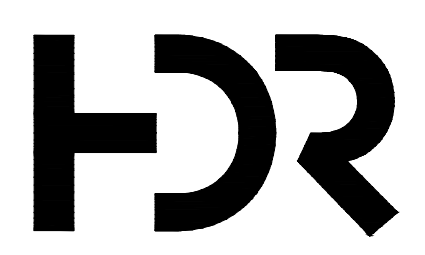

ISSUE	DATE	DESCRIPTION
6	01/12/2024	REVISED CIVIL PLAN SET PER RIDEM COMMENTS
5	11/29/2023	REVISED CIVIL PLAN SET PER RIDEM COMMENTS
4	09/29/2023	REVISED CIVIL PLAN SET FOR NEW LAYOUT
3	05/27/2022	REVISED CIVIL PLAN SET
2	05/05/2022	REVISED CIVIL PLAN SET
1	02/18/2022	CIVIL PLAN SET

PROJECT MANAGER	ANKIT DHAR
DESIGNED BY	B. PAULA
DRAWN BY	W. LIN
CHECKED BY	H. NEENAN
APPROVED BY	A. DHAR
PROJECT NUMBER	10328992

**RHODE ISLAND ENERGY
 AQUIDNECK ISLAND GAS RELIABILITY PROJECT
 OLD MILL LANE, PORTSMOUTH, RI**

TOWNSHIP OF PORTSMOUTH
 MAP 68, LOT 74

PROPOSED SITE LAYOUT PLAN

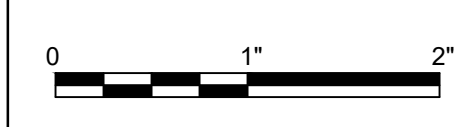

FILENAME
 SCALE 1" = 30'

SHEET 3 OF 8
 C-1

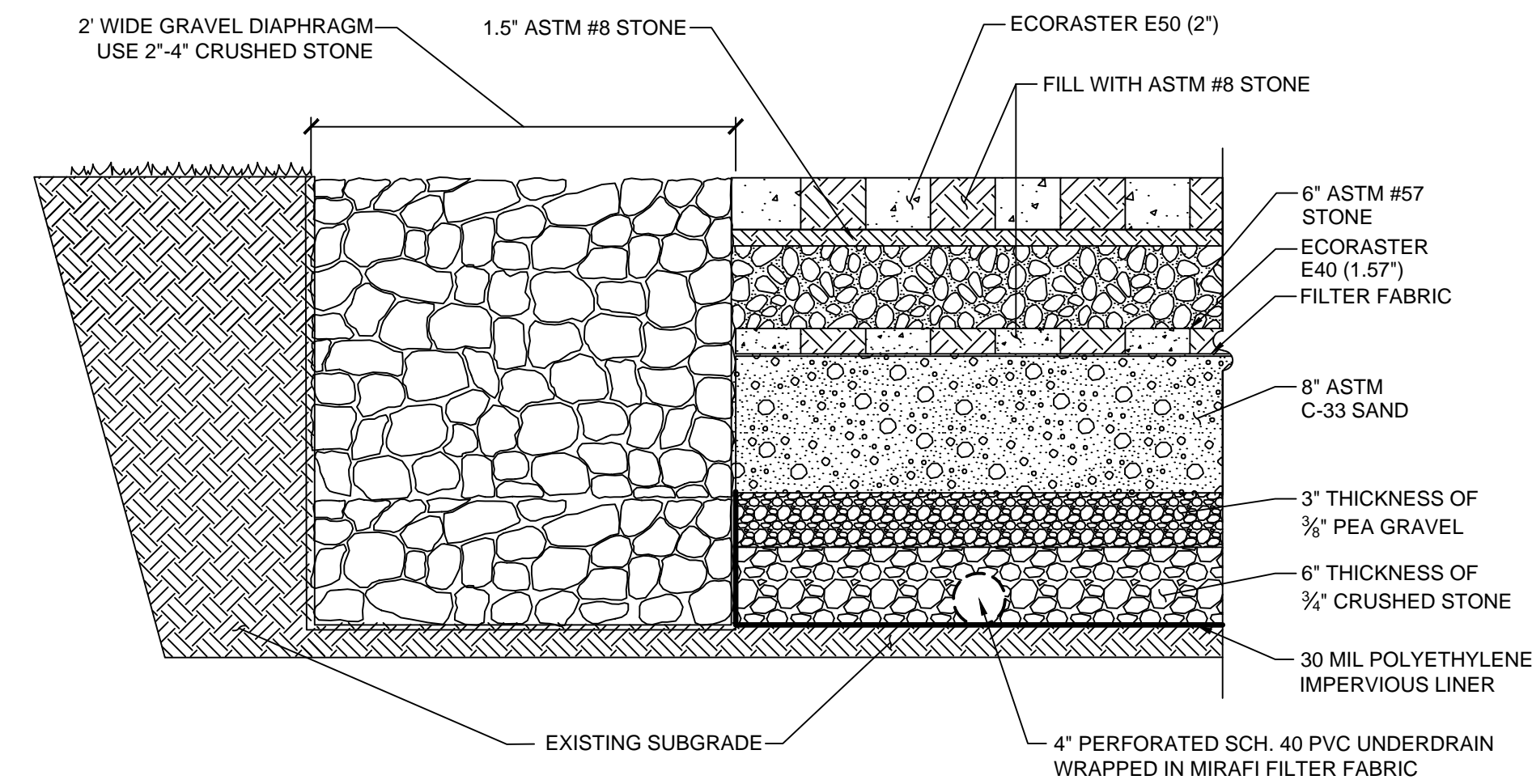

- NOTES:
1. ALL STONE SHALL BE WASHED TO REMOVE FINES.
 2. EACH LAYER OF STONE SHALL BE FINE GRADED PRIOR TO INSTALLATION OF THE NEXT.
 3. ECORASTER SHALL BE INSTALLED WITH A VIBRATING PLATE TAMPER AFTER IT IS LAID DOWN.
 4. CUTTING OF GRID PIECES SHALL BE IN ACCORDANCE WITH MANUFACTURER'S REQUIREMENTS.

PERMEABLE PAVEMENT AND GRAVEL DIAPHRAGM DETAIL

NOT TO SCALE

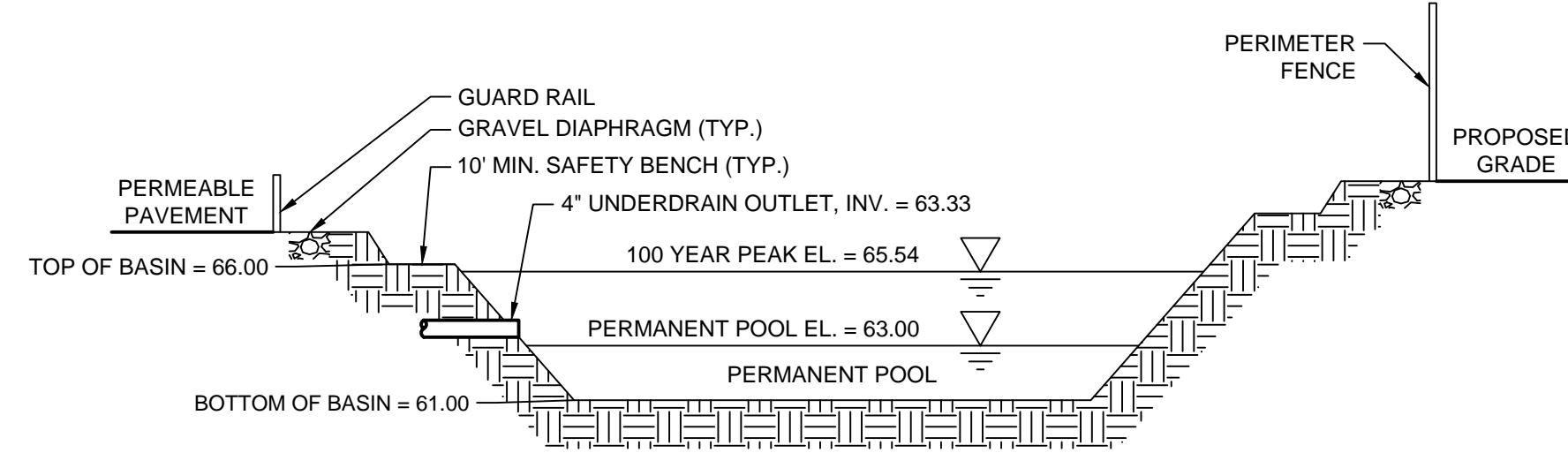
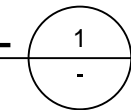

WET BASIN DETAIL

NOT TO SCALE

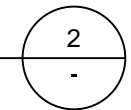

WET BASIN PLANT LIST

Zone	Description	Elevation Range	Common Name	Scientific Name	Plant or plug Density per sq. yd.	Seeding Type	Application Rate
1	Deep Water Pool	61-63	Waterweed	Elodea canadensis	1	None	N/A
			Vallisneria	Vallisneria spiralis	1		
			Wild Celery	Americanus	3		
			Arrow arum	Peltandra virginica	1		
2	Shallow Water Bench	63-66	Arrowhead	Sagittaria latifolia	3	None	N/A
			Giant Burreed	Sparganium eurycarpum	3		
			Pickeralweed	Pontederia cordata	1		
			Rice Cutgrass	Leersia oryzoides	1		
			Soft Rush	Juncus effusus	6		
			Wool Grass	Scirpus cyperinus	1		
			Spatterdock	Nuphar luteum	0.25		
			Arrow arum	Peltandra virginica	1		
			Arrowhead	Sagittaria latifolia	1		
			3	Shoreline Fringe	66-68		
Rice Cutgrass	Leersia oryzoides	1					
Soft Rush	Juncus effusus	3					
Buttonbush	Cephalanthus occidentalis	0.5					
Swamp Rose	Rosa palustris	0.25					
Switchgrass	Panicum virgatum	1					
4	Riparian Fringe/ Floodplain Terrace	69+	Elderberry	Sambucus nigra - canadensis	0.25	New England Erosion Control/Restoration Mix*	1 Lb/1250 sq ft
			Silky Dogwood	Cornus amomium	0.25		
			Swamp Rose	Rosa palustris	0.5		
			Winterberry	Ilex verticillata	0.5		
			Sweetpepperbush	Clethra alnifolia	0.25		

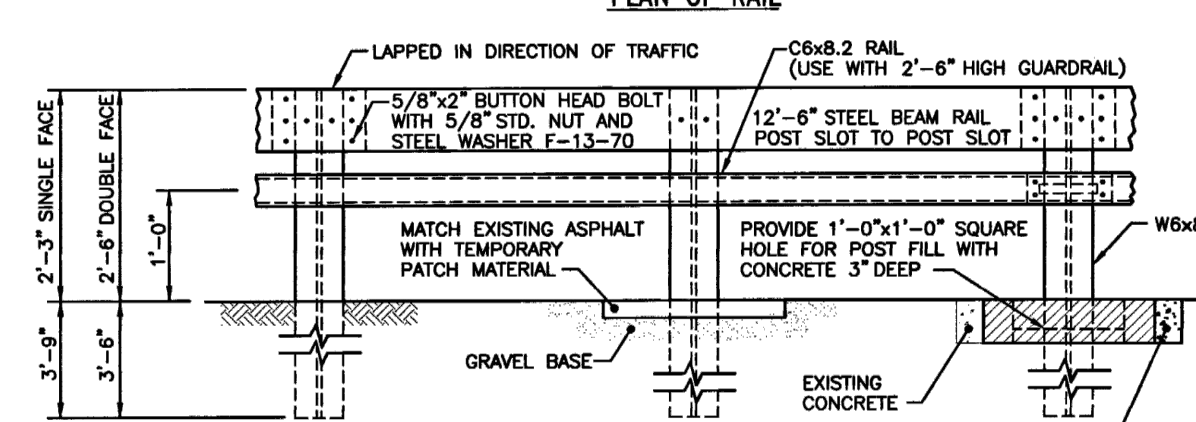
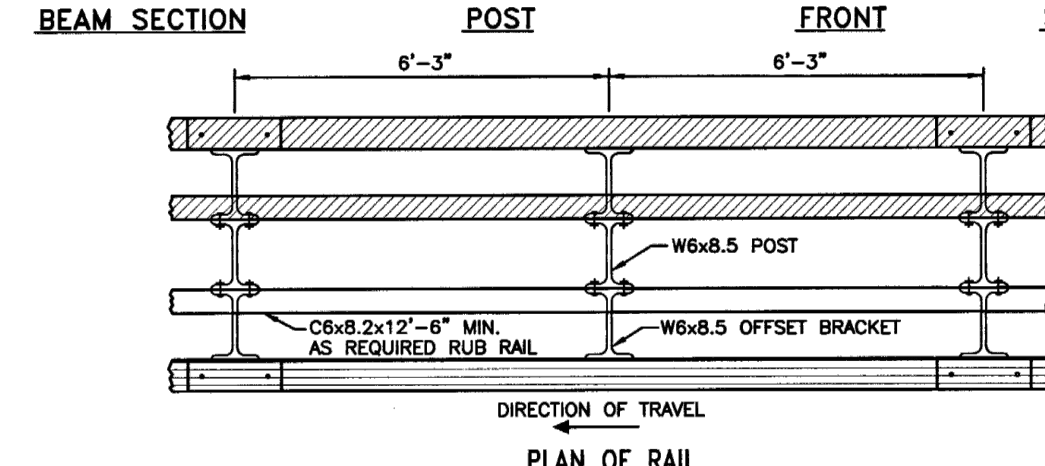
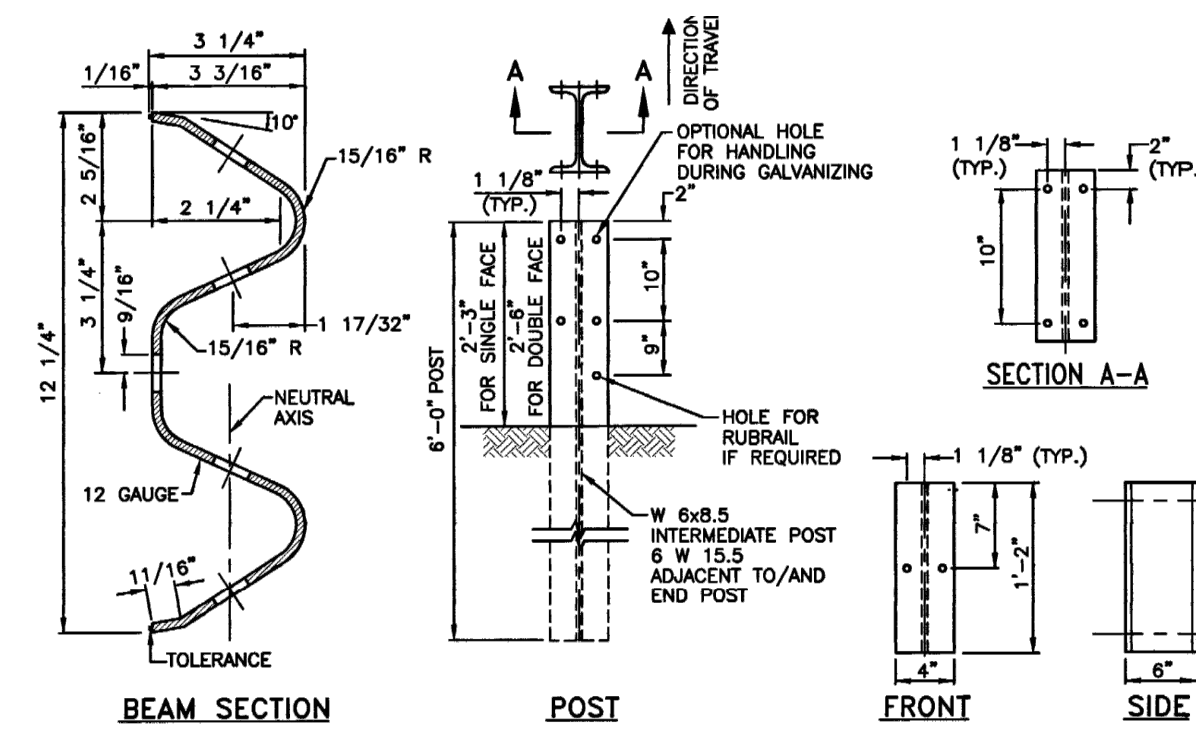

- NOTES:
1. SHALL BE IN ACCORDANCE WITH SECTION 901 OF THE R.I. STANDARD SPECIFICATIONS.
 1. POST AND OFFSET BRACKET TO BE FABRICATED FROM 6"x4" @ 1/2 LBS/FT. STEEL "H" SECTIONS.
 2. POST AND BRACKET BOLT HOLES TO BE OVAL UNLESS OTHERWISE SPECIFIED.
 4. ALL HOLES IN OFFSET BRACKETS SHALL BE 13/16\"

GUARD RAIL DETAIL

NOT TO SCALE

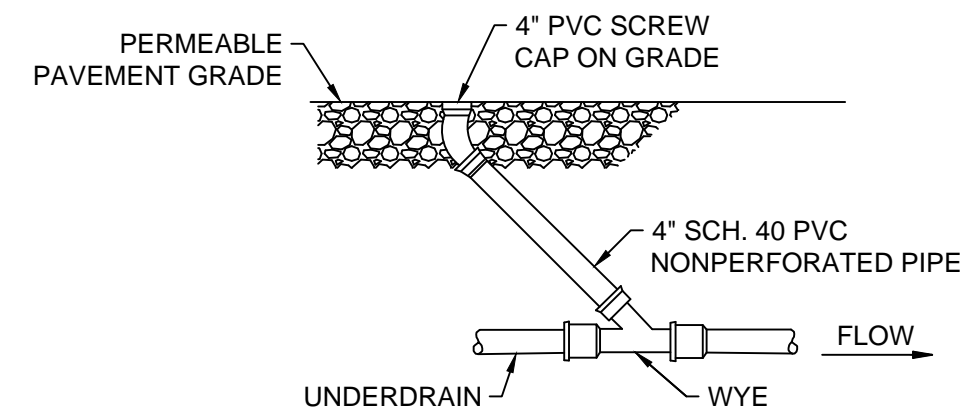
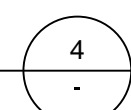

UNDERDRAIN CLEANOUT DETAIL

NOT TO SCALE

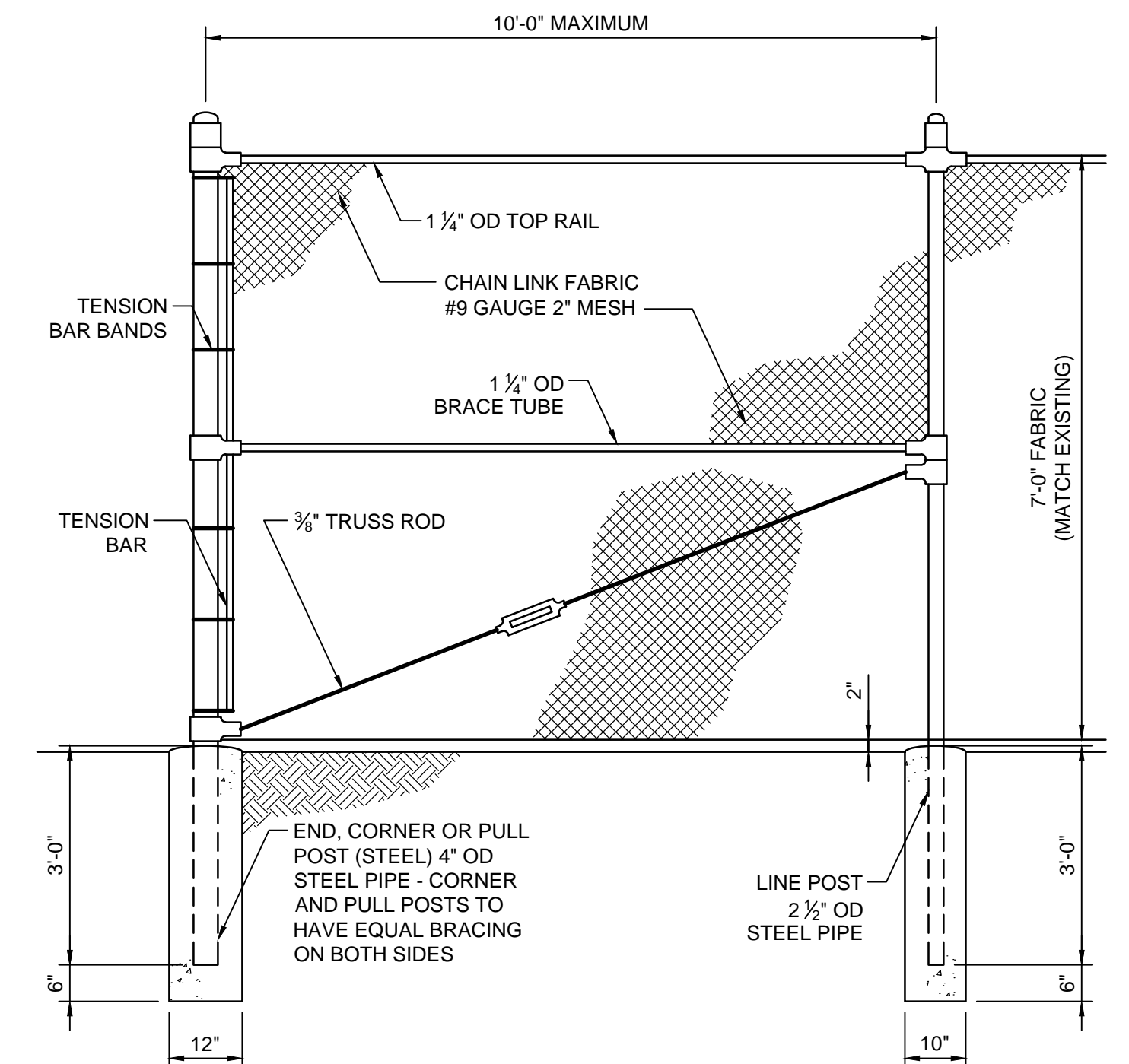
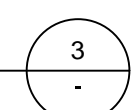

- NOTES:
1. PULL POST SHALL BE USED AT SHARP BREAKS IN VERTICAL GRADES OR AT APPROXIMATELY 330' CENTERS ON STRAIGHT RUNS, OR AS DIRECTED BY THE ENGINEER.
 2. SPLICES SHALL BE IN WOVEN WIRE FABRIC ONLY AT CORNER, GATE END, OR PULL POSTS.

FENCE DETAIL

NOT TO SCALE

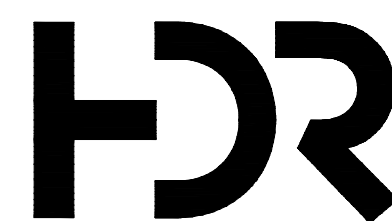
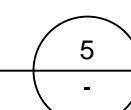

ISSUE	DATE	DESCRIPTION
6	01/12/2024	REVISED CIVIL PLAN SET PER RIDEM COMMENTS
5	11/29/2023	REVISED CIVIL PLAN SET PER RIDEM COMMENTS
4	09/29/2023	REVISED CIVIL PLAN SET FOR NEW LAYOUT
3	05/27/2022	REVISED CIVIL PLAN SET
2	05/05/2022	REVISED CIVIL PLAN SET
1	02/18/2022	CIVIL PLAN SET

PROJECT MANAGER ANKIT DHAR

DESIGNED BY B. PAULA
 DRAWN BY W. LIN
 CHECKED BY H. NEENAN
 APPROVED BY A. DHAR

PROJECT NUMBER 10328992

**RHODE ISLAND ENERGY
 AQUIDNECK ISLAND GAS RELIABILITY PROJECT
 OLD MILL LANE, PORTSMOUTH, RI**

TOWNSHIP OF PORTSMOUTH
 MAP 68, LOT 74



CIVIL DETAILS

FILENAME
 SCALE NOT TO SCALE

SHEET 4 OF 8

C-2





- NOTES:**
1. SOIL EROSION & SEDIMENT CONTROL SHALL BE STRICTLY ENFORCED.
 2. FOR EXCAVATIONS WHERE GROUNDWATER IS ENCOUNTERED, CONTRACTOR SHALL USE APPROPRIATE DEWATERING METHOD SUCH AS A REMOVABLE PUMP STATION. PUMPED WATER SHALL BE DIRECTED THROUGH A FILTERING DEVICE SUCH AS A FILTER BAG PRIOR TO DISCHARGE.
 3. CONTRACTOR SHALL SWEEP THE PORTIONS OF OLD MILL LANE ADJACENT TO THE PROJECT SITE AT THE END OF EACH WORKING DAY.
 4. REFER TO SOIL EROSION & SEDIMENT CONTROL DETAIL SHEETS FOR MAINTENANCE REQUIREMENTS OF EACH SOIL EROSION & SEDIMENT CONTROL PRACTICE.
 5. REFER TO SOIL EROSION & SEDIMENT CONTROL PLAN PROVIDED UNDER SEPARATE COVER.

- EROSION & SEDIMENT CONTROL - PHASE 1 SEQUENCE:**
1. THE LIMITS OF DISTURBANCE AND THE LIMITS OF ALL WETLANDS SHALL BE FIELD MARKED PRIOR TO CLEARING, GRUBBING, INSTALLATION OF EROSION AND SEDIMENT CONTROL MEASURES, CONSTRUCTION OR OTHER LAND DISTURBING ACTIVITIES. THE LOCATION(S) OF ALL UTILITIES SHALL BE MARKED OUT.
 2. INSTALL STABILIZED CONSTRUCTION ENTRANCE.
 3. INSTALL PERIMETER EROSION AND SEDIMENT CONTROLS, INCLUDING COMPOST FILTER SOCK.
 4. INSTALL CONCRETE WASHOUT FACILITY AND LOCATE DEWATERING FILTER BAG AS NEEDED FOR CONSTRUCTION.
 5. PERFORM CLEARING AND GRUBBING ACTIVITIES.
 6. PLACE TEMPORARY STABILIZATION/VEGETATION FOR ALL AREAS THAT ARE TO REMAIN UNDISTURBED FOR MORE THAN SEVEN (7) CALENDAR DAYS.

- EROSION & SEDIMENT CONTROL - PHASE 2 SEQUENCE:**
1. CONSTRUCT PERMANENT SITE FEATURES INCLUDING PERVIOUS PAVEMENT, FENCING, AND WET BASIN.
 2. REMOVE CONCRETE WASHOUT STRUCTURE ONCE IT IS NO LONGER NEEDED.
 3. ONCE PERMANENT STABILIZATION HAS BEEN ESTABLISHED, REMOVE EROSION AND SEDIMENT CONTROL MEASURES.

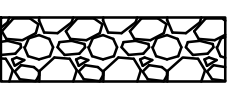
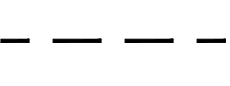
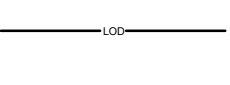
LEGEND

-  STABILIZED CONSTRUCTION ENTRANCE
-  12" COMPOST FILTER SOCK
-  LIMIT OF DISTURBANCE
-  EXISTING WETLANDS
-  PERIMETER WETLANDS

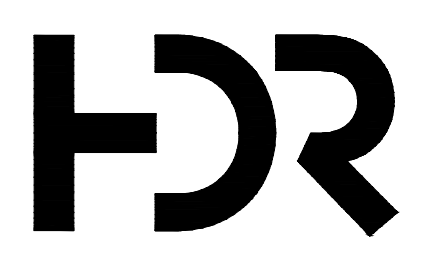

ISSUE	DATE	DESCRIPTION
6	01/12/2024	REVISED CIVIL PLAN SET PER RIDEM COMMENTS
5	11/29/2023	REVISED CIVIL PLAN SET PER RIDEM COMMENTS
4	09/29/2023	REVISED CIVIL PLAN SET FOR NEW LAYOUT
3	05/27/2022	REVISED CIVIL PLAN SET
2	05/05/2022	REVISED CIVIL PLAN SET
1	02/18/2022	CIVIL PLAN SET

PROJECT MANAGER ANKIT DHAR	
DESIGNED BY	B. PAULA
DRAWN BY	W. LIN
CHECKED BY	H. NEENAN
APPROVED BY	A. DHAR
PROJECT NUMBER 10328992	

**RHODE ISLAND ENERGY
AQUIDNECK ISLAND GAS RELIABILITY PROJECT
OLD MILL LANE, PORTSMOUTH, RI**

TOWNSHIP OF PORTSMOUTH
MAP 68, LOT 74

EROSION & SEDIMENT CONTROL PLAN

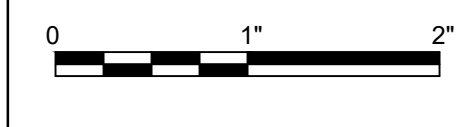

FILENAME: SHEET 5 OF 8
SCALE: 1" = 30'
C-3

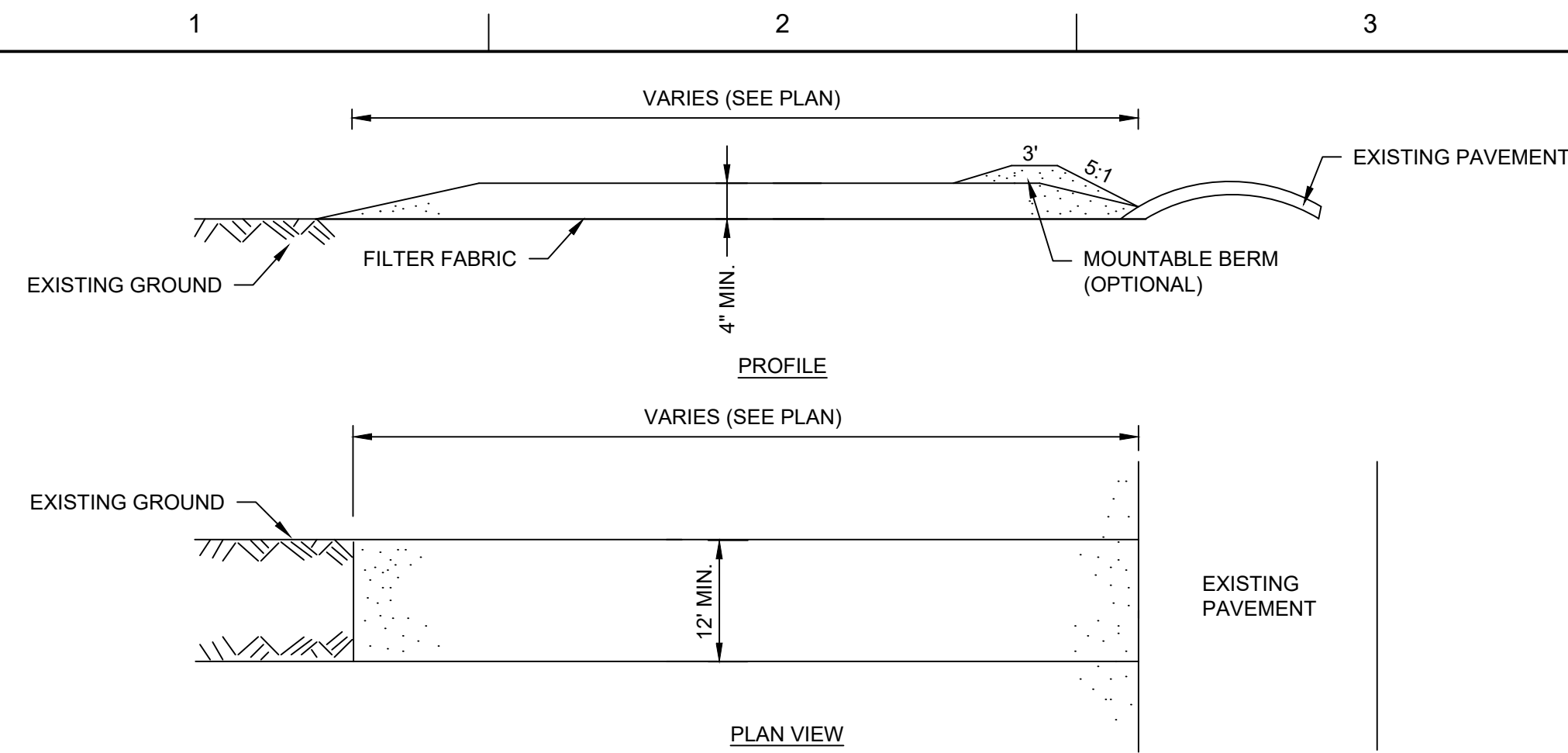

CONSTRUCTION SPECIFICATIONS:

1. STONE SIZE - USE RI DOT 2" STONE, OR RECLAIMED OR RECYCLED CONCRETE EQUIVALENT.
2. LENGTH - NOT LESS THAN 100 FEET.
3. THICKNESS - NOT LESS THAN FOUR (4) INCHES.
4. WIDTH - TWELVE (12) FOOT MINIMUM, BUT NOT LESS THAN THE FULL WIDTH AT POINTS WHERE INGRESS OR EGRESS OCCURS. TWENTY-FOUR (24) FOOT IF SINGLE ENTRANCE TO SITE.
5. FILTER CLOTH - WILL BE PLACED OVER THE ENTIRE AREA PRIOR TO PLACING OF STONE.
6. SURFACE WATER - ALL SURFACE WATER FLOWING OR DIVERTED TOWARD CONSTRUCTION ENTRANCES SHALL BE PIPED ACROSS THE ENTRANCE. IF PIPING IS IMPRACTICAL, A MOUNTABLE BERM WITH 5:1 SLOPES WILL BE PERMITTED.
7. MAINTENANCE - THE ENTRANCE SHALL BE MAINTAINED IN A CONDITION WHICH WILL PREVENT TRACKING OR FLOWING OF SEDIMENT ONTO PUBLIC RIGHTS-OF-WAY. ALL SEDIMENT SPILLED, DROPPED, WASHED OR TRACTED ONTO PUBLIC RIGHTS-OF-WAY MUST BE REMOVED IMMEDIATELY.
8. WHEN WASHING IS REQUIRED, IT SHALL BE DONE ON A AREA STABILIZED WITH STONE AND WHICH DRAINS INTO AN APPROVED SEDIMENT TRAPPING DEVICE.
9. PERIODIC INSPECTION AND NEEDED MAINTENANCE SHALL BE PROVIDED AFTER EACH RAIN.

STABILIZED CONSTRUCTION ENTRANCE

NOT TO SCALE

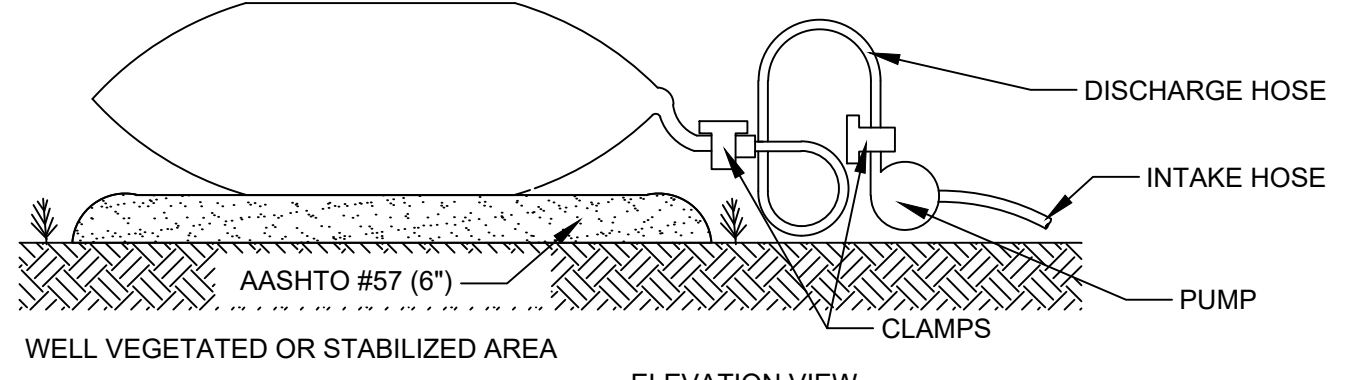
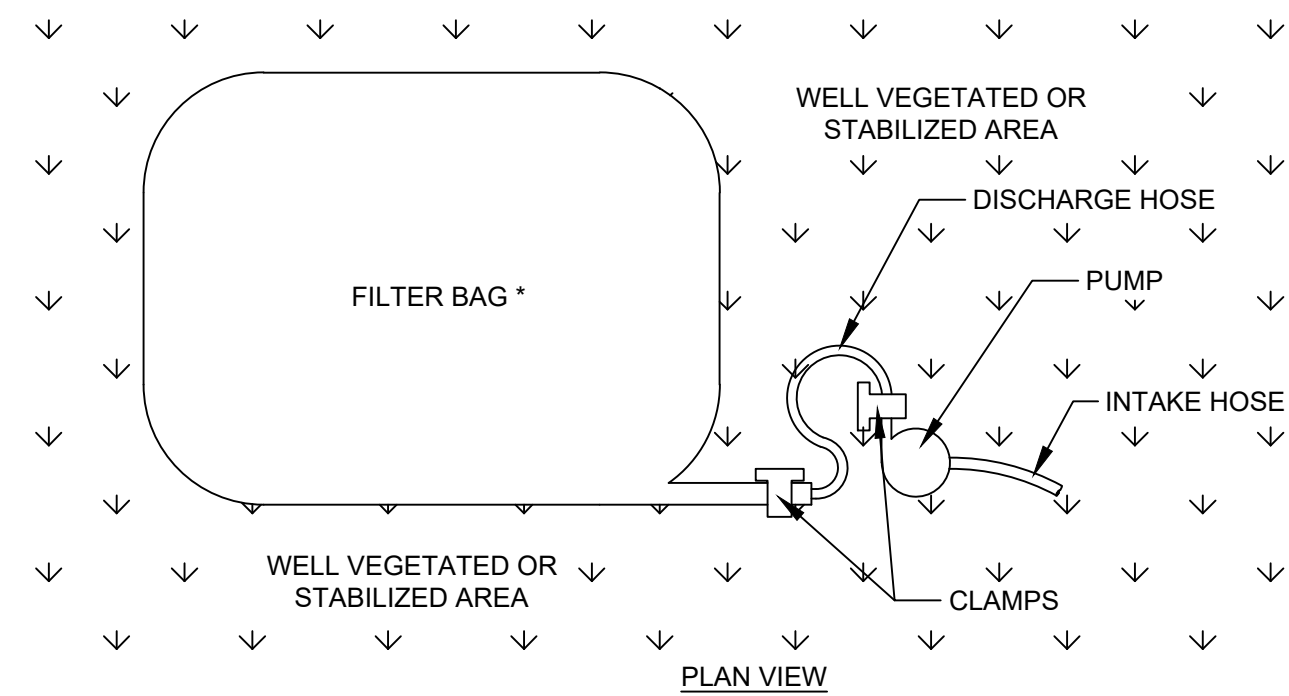
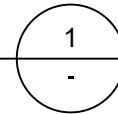

NOTES:

1. * NON-WOVEN GEOTEXTILE FILTER BAG WHICH RETAINS ALL SEDIMENT PARTICLES LARGER THAN 150 MICRONS.
2. PLACE FILTER BAGS ON STABLE OR WELL VEGETATED AREAS WHICH ARE FLATTER THAN 5% AND WHICH WILL NOT ERODE WHEN SUBJECTED TO BAG DISCHARGES.
3. CLAMP PUMP DISCHARGE HOSES SECURELY INTO FILTER BAGS. LIMIT PUMPING RATE TO 1/2 THE MANUFACTURER'S MAXIMUM PUMPING RATE.
4. WHEN SEDIMENTS FILL 1/2 THE VOLUME OF A FILTER BAG, IMMEDIATELY REMOVE THAT BAG FROM SERVICE.
5. PROPERLY DISPOSE OF SPENT BAGS WITH THEIR SEDIMENTS.
6. THE DISCHARGE FROM THE FILTER BAG SHOULD NOT PASS THROUGH A DISTURBED AREA OR CAUSE AN EROSION PROBLEM DOWN SLOPE.

DEWATERING FILTER BAG DETAIL

NOT TO SCALE

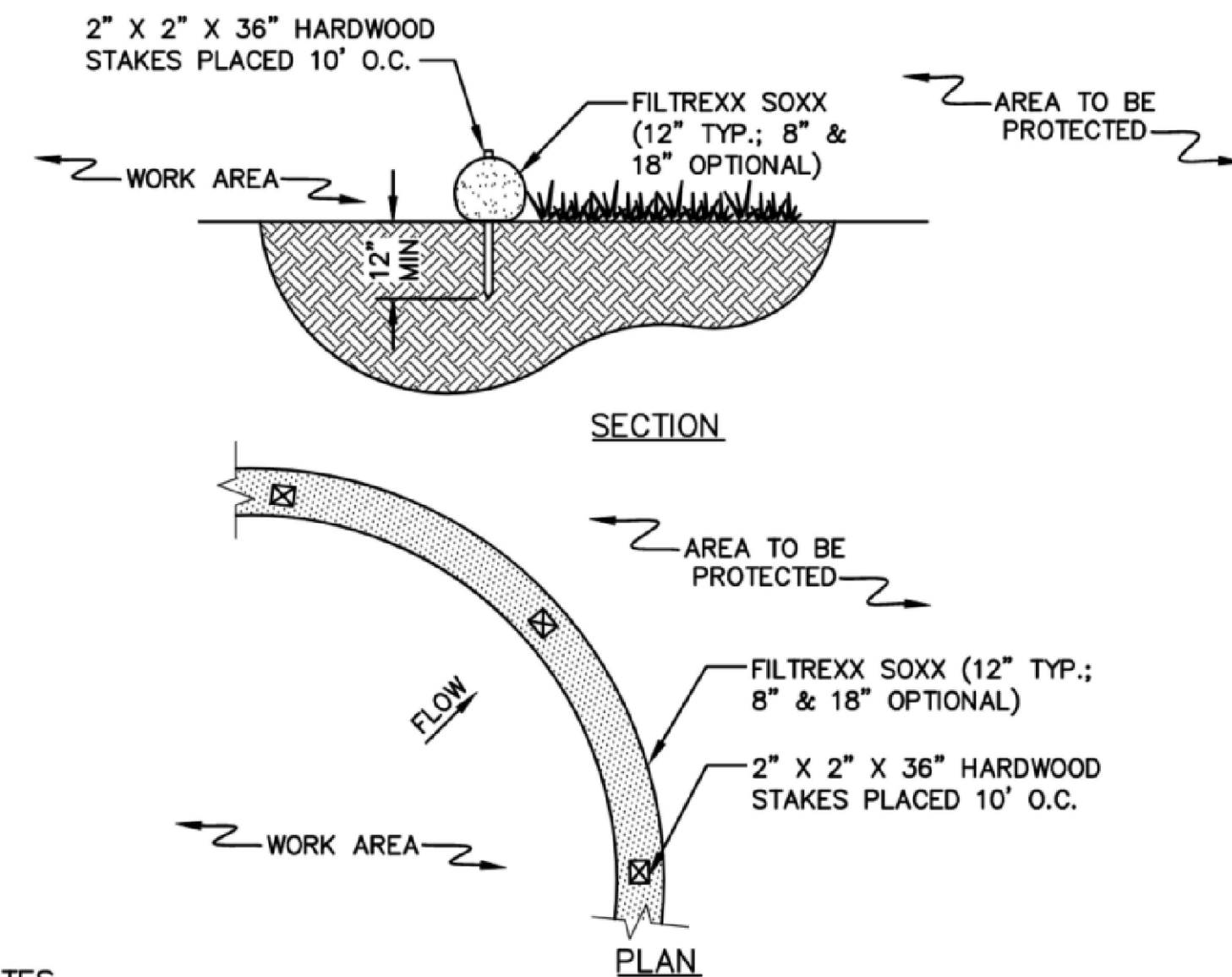
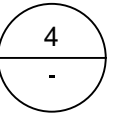

NOTES:

1. PRODUCT TO BE FILTREXX SILT SOXX OR APPROVED EQUAL BY NATIONAL GRID ENVIRONMENTAL SCIENTIST.
2. ALL MATERIAL TO MEET FILTREXX SPECIFICATIONS.
3. FILTER MEDIA FILL TO MEET APPLICATION REQUIREMENTS.
4. MESH CONTAINMENT MATERIAL SHOULD BE KNITTED PHOTODEGRADABLE OR BIODEGRADABLE MATERIAL, WITH OPENING SIZES BETWEEN 1/8" - 3/8".
5. COMPOST MEDIA SHOULD HAVE PARTICLE SIZE WHERE 99% < 2", 50% > 1/2".
6. COMPOST MATERIAL TO BE DISPERSED ON SITE, AS DETERMINED BY NATIONAL GRID ENVIRONMENTAL SCIENTIST.

COMPOST FILTER SOCK DETAIL

NOT TO SCALE

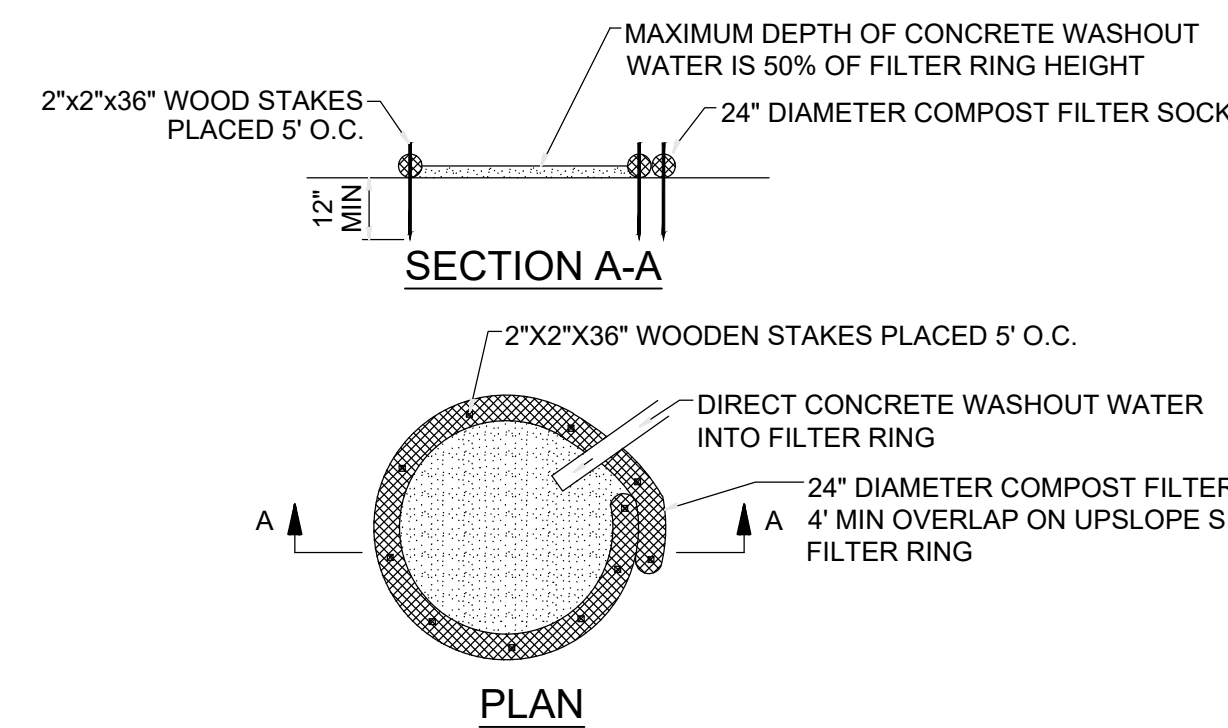
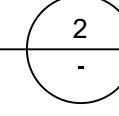

NOTES:

1. 18" DIAMETER FILTER SOCK MAY BE STACKED ONTO DOUBLE 24" DIAMETER SOCKS IN PYRAMIDAL CONFIGURATION FOR ADDED HEIGHT.
2. A SUITABLE IMPERVIOUS GEOMEMBRANE SHALL BE PLACED AT THE LOCATION OF THE WASHOUT PRIOR TO INSTALLING THE SOCKS.
3. FOR ANY PROJECT ON WHICH CONCRETE WILL BE POURED OR OTHERWISE FORMED ON SITE, A SUITABLE WASHOUT FACILITY MUST BE PROVIDED FOR THE CLEANING OF CHUTES, MIXERS, AND HOPPERS OF THE DELIVERY VEHICLES UNLESS SUCH A FACILITY WILL BE USED AT THE SOURCE OF THE CONCRETE. UNDER NO CIRCUMSTANCES MAY WASH WATER FROM THESE VEHICLES BE ALLOWED TO ENTER ANY SURFACE WATERS.
4. MAKE SURE THAT PROPER SIGNAGE IS PROVIDED TO DRIVERS SO THAT THEY ARE AWARE OF THE PRESENCE OF WASHOUT FACILITIES.
5. WASHOUT FACILITIES SHOULD NOT BE PLACED WITHIN 50 FEET OF STORM DRAINS, OPEN DITCHES OR SURFACE WATERS. THEY SHOULD BE IN A CONVENIENT LOCATION FOR THE TRUCKS, PREFERABLY NEAR THE PLACE WHERE THE CONCRETE IS BEING POURED, BUT FAR ENOUGH FROM OTHER VEHICULAR TRAFFIC TO MINIMIZE THE POTENTIAL FOR ACCIDENTAL DAMAGE OR SPILLS. WHEREVER POSSIBLE, THEY SHOULD BE LOCATED ON SLOPES NOT EXCEEDING A 2% GRADE.

MAINTENANCE:

ALL CONCRETE WASHOUT FACILITIES SHOULD BE INSPECTED DAILY. DAMAGED OR LEAKING WASHOUTS SHOULD BE DEACTIVATED AND REPAIRED OR REPLACED IMMEDIATELY. ACCUMULATED MATERIALS SHOULD BE REMOVED WHEN THEY REACH 75% CAPACITY. PLASTIC LINERS SHOULD BE REPLACED WITH EACH CLEANING OF THE WASHOUT FACILITY.

CONCRETE WASHOUT DETAIL

NOT TO SCALE

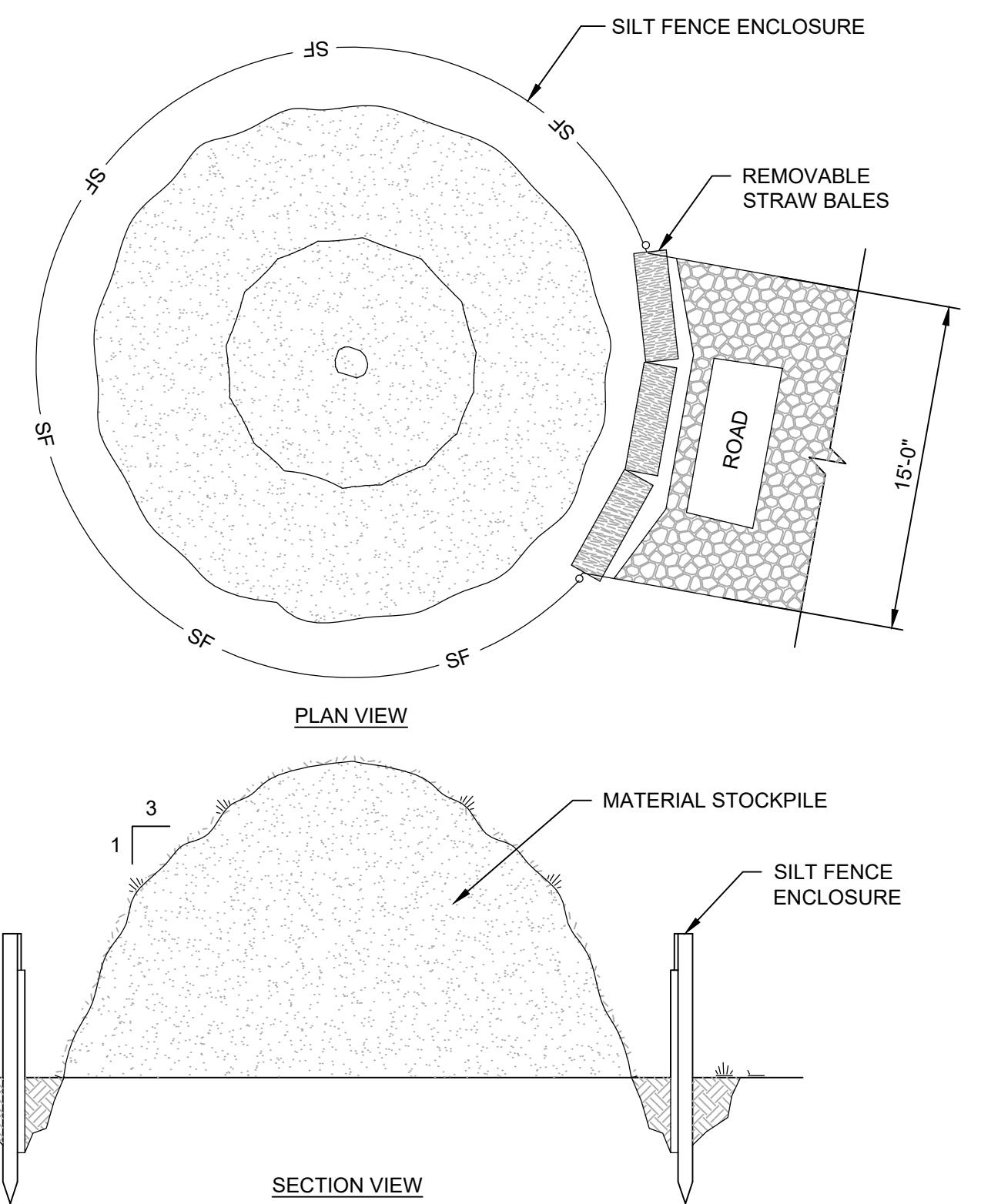
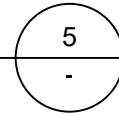

NOTES:

1. SOIL REMOVED DURING SITE PREPARATION SHALL BE STOCKPILED ON-SITE AT A MAXIMUM SLOPE OF 3:1.
2. STOCKPILE SHALL BE ENCIRCLED WITH SILT FENCING, AS PER SILT FENCING DETAIL, WITH PASSAGEWAY PROVIDED FOR EQUIPMENT ACCESS.

TEMPORARY MATERIAL STOCKPILE DETAIL

NOT TO SCALE

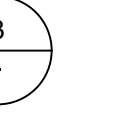

ISSUE	DATE	DESCRIPTION
6	01/12/2024	REVISED CIVIL PLAN SET PER RIDEM COMMENTS
5	11/29/2023	REVISED CIVIL PLAN SET PER RIDEM COMMENTS
4	09/29/2023	REVISED CIVIL PLAN SET FOR NEW LAYOUT
3	05/27/2022	REVISED CIVIL PLAN SET
2	05/05/2022	REVISED CIVIL PLAN SET
1	02/18/2022	CIVIL PLAN SET

PROJECT MANAGER	ANKIT DHAR
DESIGNED BY	B. PAULA
DRAWN BY	W. LIN
CHECKED BY	H. NEENAN
APPROVED BY	A. DHAR
PROJECT NUMBER	10328992

**RHODE ISLAND ENERGY
AQUIDNECK ISLAND GAS RELIABILITY PROJECT
OLD MILL LANE, PORTSMOUTH, RI**

TOWNSHIP OF PORTSMOUTH
MAP 68, LOT 74

EROSION & SEDIMENT CONTROL DETAILS



FILENAME
SCALE NOT TO SCALE

SHEET 6 OF 8
C-4

SEEDING NOTES

1. NEW ENGLAND WETMIX TO BE USED WITHIN FLAGGED WETLAND AND INSTALLED VIA SLICE SEEDING.

FROM NEW ENGLAND WETLAND PLANTS, INC. AMHERST, MASSACHUSETTS

SEEDING: ALWAYS APPLY ON CLEAN BARE SOIL. THE WETLAND SEEDS IN THIS MIX CAN BE HAND SOWN, USED WITH A HAND-HELD SPREADER, OR HYDRO-SEEDED ON LARGE OR HARD TO REACH SITES, AS LONG AS THERE IS NO PERMANENT SNOW COVER. LIGHTLY RAKE TO ENSURE PROPER SOIL-SEED CONTACT. SEEDING CAN TAKE PLACE ON FROZEN SOIL AS THE FREEZING, THAWING WEATHER OF LATE FALL AND LATE WINTER WILL WORK THE SEED INTO THE SOIL. IF SPRING CONDITIONS ARE DRIER THAN USUAL, WATERING MAY BE REQUIRED. IF PLANTING DURING THE SUMMER MONTHS, WATERING MAY BE REQUIRED FOR AT LEAST 2-3 WEEKS AFTER PLANTING TO ENSURE GERMINATION. A NON-INVASIVE ANNUAL SUCH AS WINTER RYE MAY BE ADDED TO THE MIX TO OBTAIN SOIL STABILIZATION COVER IN THE FALL. DO NOT ADD ANNUAL RYEGRASS, KENTUCKY BLUEGRASS OR PERENNIAL RYEGRASS AS THESE SPECIES ARE VERY AGGRESSIVE AND THEY WILL INHIBIT THE GROWTH OF THE WETLAND SEEDS. A LIGHT MULCH OF CLEAN, WEED FREE STRAW IS RECOMMENDED.

NOTE: SEEDS WILL NOT GERMINATE UNDER INUNDATED CONDITIONS. NOT ALL SPECIES WILL GROW IN ALL WETLAND SITUATIONS.

APPLICATION RATE: 1 LB/2500 SQ. FT.

TYPICAL SPECIES: FOX SEDGE (CAREX VULPINOIDEA), SALLOW SEDGE (CAREX LURIDA), BROOM SEDGE (CAREX SCOPARIA), SENSITIVE FERN (ONOCLEA SENSIBILIS), BLUE VERVAIN (VERBENA HASTATA), HOP SEDGE (CAREX LUPULINA), DARK-GREEN BULRUSH (SCIRPUS ATROVIRENS), NODDING BUR-MARIGOLD (BIDENS CERNUA), BRISTLY SEDGE (CAREX COMOSA), FRINGED SEDGE (CAREX CRINITA), TALL MANNAGRASS (GLYCERIA GRANDIS), WOOL-GRASS (SCIRPUS CYPERRINUS), SOFT RUSH (JUNCUS EFFUSUS), SPOTTED JOE-PYE-WEED (EUTROCHUM MACULATUM), BONESET (EUPATORIUM PERFOLIATUM), AMERICAN WATER-PLANTAIN (ALISMA SUBCORDATUM), NEW ENGLAND ASTER (SYMPHYOTRICHUM NOVAE-ANGLIAE), RATTLESNAKE MANNAGRASS (GLYCERIA CANADENSIS), PURPLE-STEM ASTER (SYMPHYOTRICHUM PUNICEUM), SOFT-STEMMED BULRUSH (SCHOENOPLECTUS TABERNAEMONTANI), BLUEFLAG (IRIS VERSICOLOR), SWAMP MILKWEED (ASCLEPIAS INCARNATA), AND ALLEGHENY MONKEY-FLOWER (MIMULUS RINGENS).

2. SEED MIX TO BE USED IN THE 50-FOOT PERIMETER WETLAND WILL BE COMPRISED OF A NATIVE POLLINATOR MIX.

Recommended Pollinator Habitat Seed Mix Table

Common name	Scientific name	Percent composition
Little Bluestem	<i>Schizachyrium scoparium</i>	35.0%
Sundial Lupine	<i>Lupinus perennis</i>	15.0%
Partridge Pea	<i>Chamaecrista fasciculata</i>	15.0%
Round-head Bush Clover	<i>Lespedeza capitata</i>	11.0%
Wild Bergamot	<i>Monarda fistulosa</i>	10.0%
Butterfly Milkweed	<i>Asclepias tuberosa</i>	10.0%
Hyssop-leaved Thoroughwort	<i>Eupatorium hyssopifolium</i>	1.1%
Showy Goldenrod	<i>Solidago speciosa</i>	1.0%
Gray Goldenrod	<i>Solidago nemoralis</i>	1.0%
Blue Wood (Heartleaf) Aster	<i>Symphotrichum cordifolium</i>	0.5%
False Indigo	<i>Baptisia tinctoria</i>	0.2%
New York Ironweed	<i>Vernonia noveboracensis</i>	0.2%

APPLY POLLINATOR MIX AT 5LBS/ACRE.

NOTE: THIS MIX MAY BE VARIED BASED ON SEED AVAILABILITY. THE ADDITION OF OTHER NATIVE SPECIES, INCLUDING GRASSES IS ENCOURAGED. THE MIX SHALL PRODUCE A HIGH QUALITY PERENNIAL MIX THAT IS HIGHLY ATTRACTIVE TO POLLINATORS. USE SLICE SEEDING TO INSTALL THE SEED.

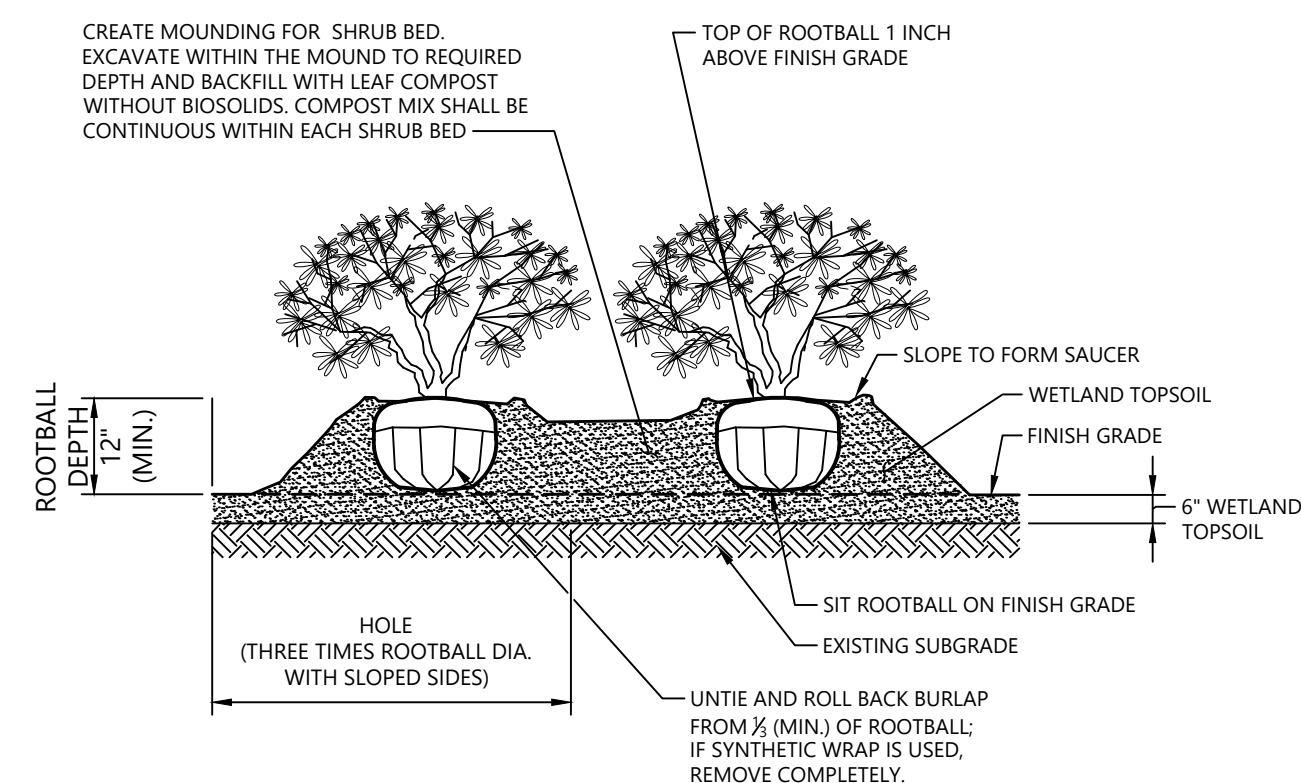

- NOTES**
1. LOOSEN ROOTS AT THE OUTER EDGE OF ROOTBALL OF CONTAINER GROWN SHRUBS.

Shrub Planting

N.T.S. Source: VHB LD_601R

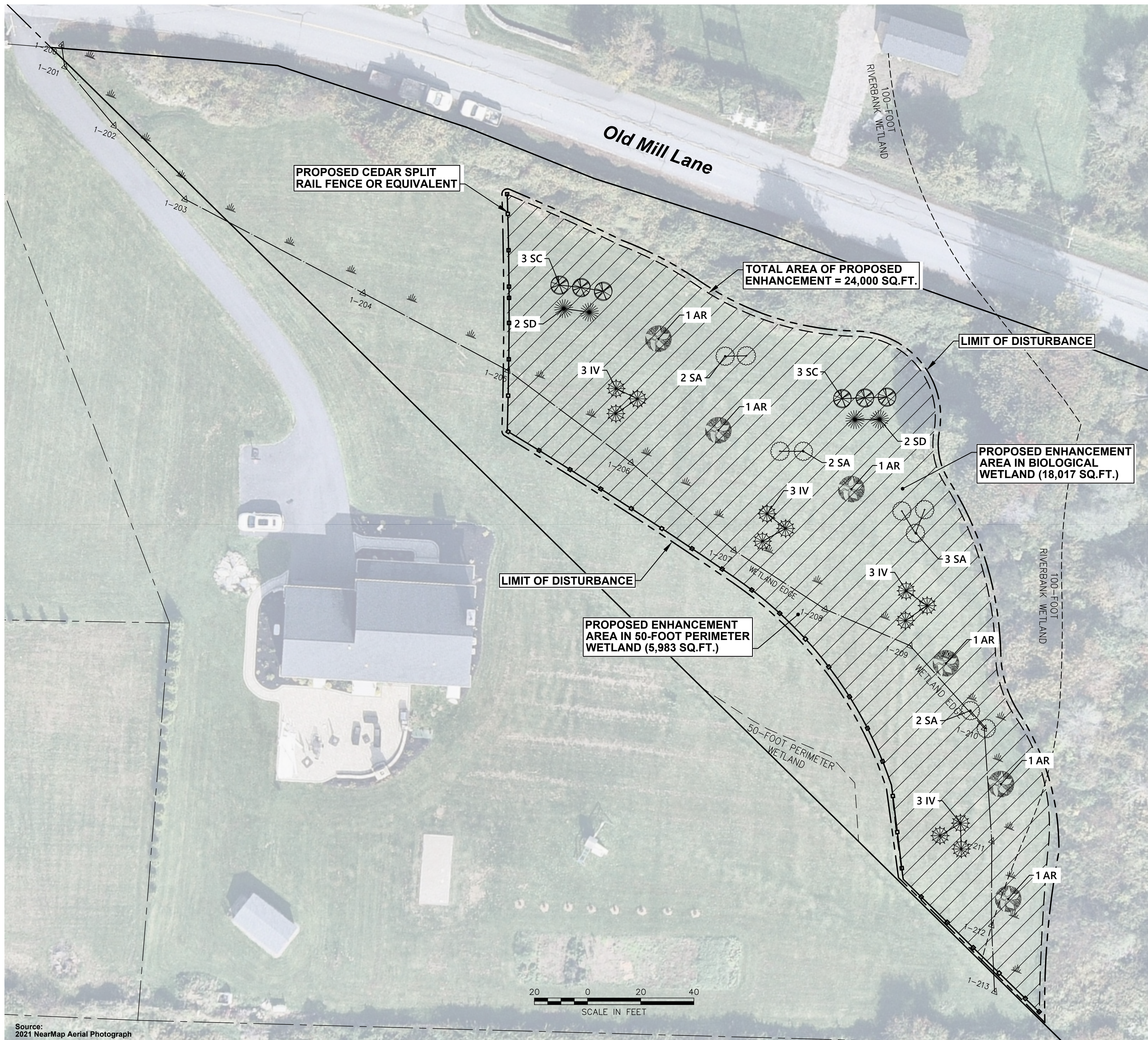

Old Mill Lane Wetland Mitigation/Enhancement Plan

Old Mill Lane
Portsmouth, Rhode Island

No.	Revision	Date	App'd.
1	RESPONSE TO RIDEM'S DEC. 12, 2022 COMMENTS	09-29-2023	
2	RIDEM COMMENT RESPONSE	11-15-2023	

Designed by: _____ Checked by: _____
Issued for: _____ Date: _____

RIDEM Application to Alter Freshwater Wetlands 6-22-2022

Drawing Title
Planting Plan

Drawing Number

SHRUBS	SCIENTIFIC NAME	COMMON NAME	SIZE	QUANTITY
IV	<i>Ilex verticillata</i>	Winterberry	2 - 3' Height	12
SC	<i>Sambucus canadensis</i>	American Elderberry	2 - 3' Height	6
SD	<i>Salix discolor</i>	Pussy Willow	2 - 3' Height	4
SA	<i>Swida amomum</i>	Silky Dogwood	2 - 3' Height	9
TREES	SCIENTIFIC NAME	COMMON NAME	SIZE	QUANTITY
AR	<i>Acer rubrum</i>	Red Maple	3' Height	6

Legend

△	Verified Wetland Flag		Proposed Enhancement Area
—	Verified Wetland Edge	—○—	Proposed Cedar Split Rail Fence or Equivalent
- - - - -	50' Perimeter Wetland	- - - - -	Proposed Limit of Disturbance
- - - - -	100' Riverbank Wetland		

P-1

Sheet 7 of 8

Project Number 73195.00

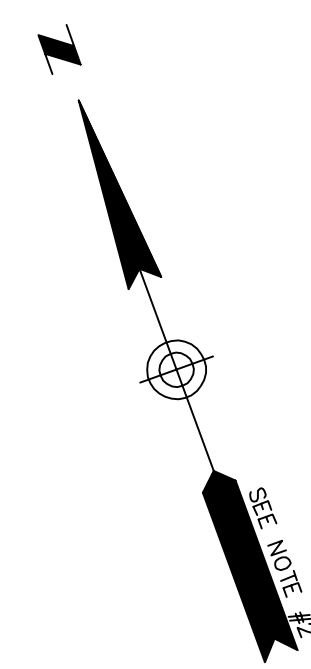
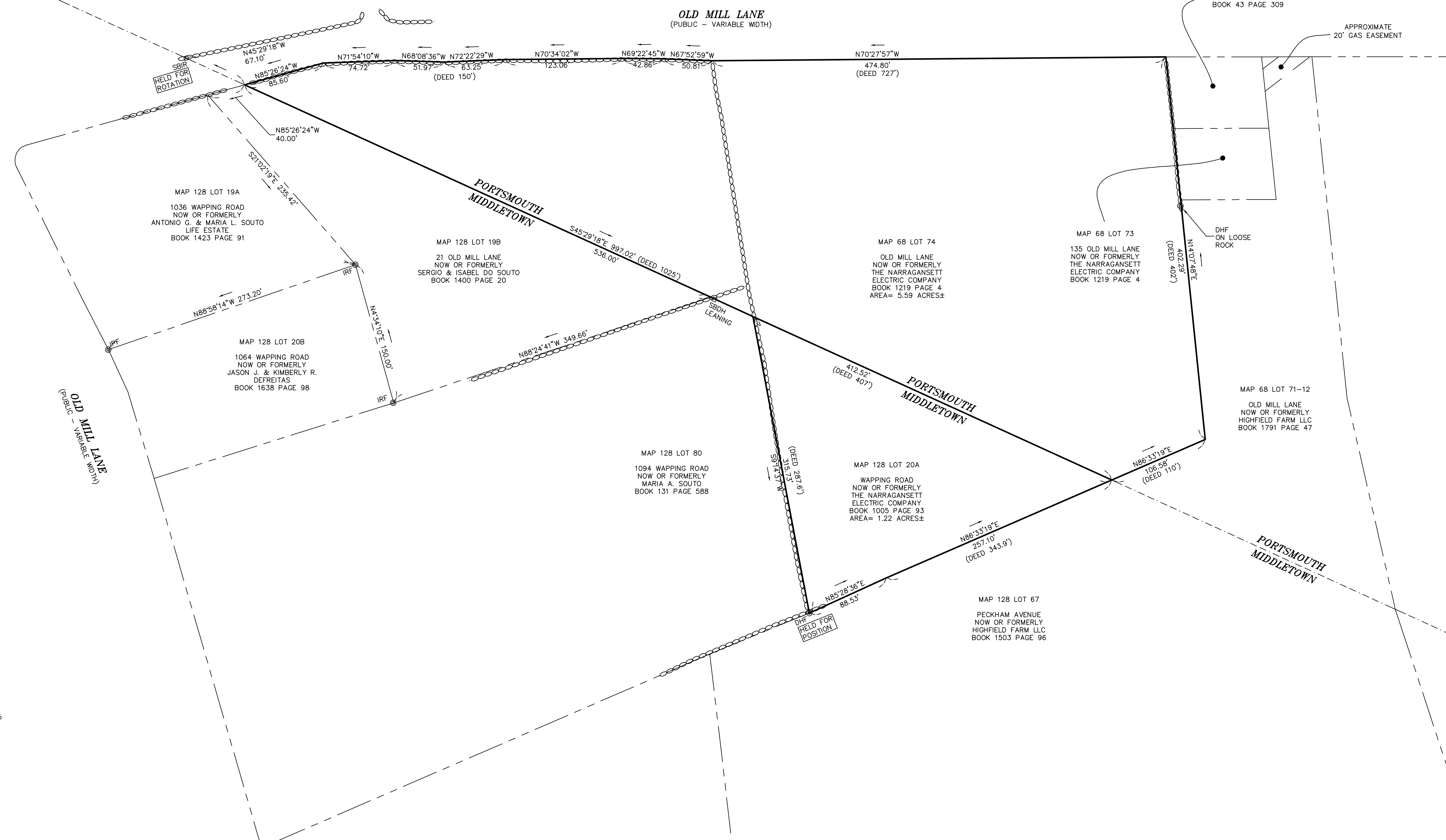

LEGEND

- SBCH □ STONE BOUND WITH DRILL HOLE
- SBIR □ STONE BOUND WITH IRON ROD
- DHF ⊙ DRILL HOLE FOUND
- IRF ⊙ IRON PIPE FOUND
- IRP ⊙ IRON ROD FOUND
- ABUTTERS LOT LINE
- PROPERTY LINE
- EASEMENT
- TOWNLINE
- STONE WALL

CERTIFICATION

THIS SURVEY HAS BEEN CONDUCTED AND THE PLAN HAS BEEN PREPARED PURSUANT TO SECTION 9 OF THE RULES AND REGULATIONS ADOPTED BY THE RHODE ISLAND STATE BOARD OF REGISTRATION FOR PROFESSIONAL LAND SURVEYORS ON NOVEMBER 25, 2015, AS FOLLOWS: COMPREHENSIVE BOUNDARY SURVEY, CLASS I.

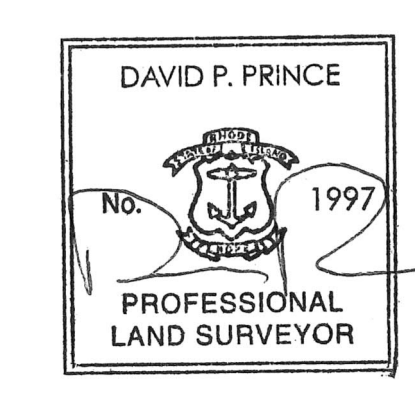

WSP USA, Inc. COA NO. LS-A486 DATE: 07/29/21
 DAVID P. PRINCE RPLS NO. 1997

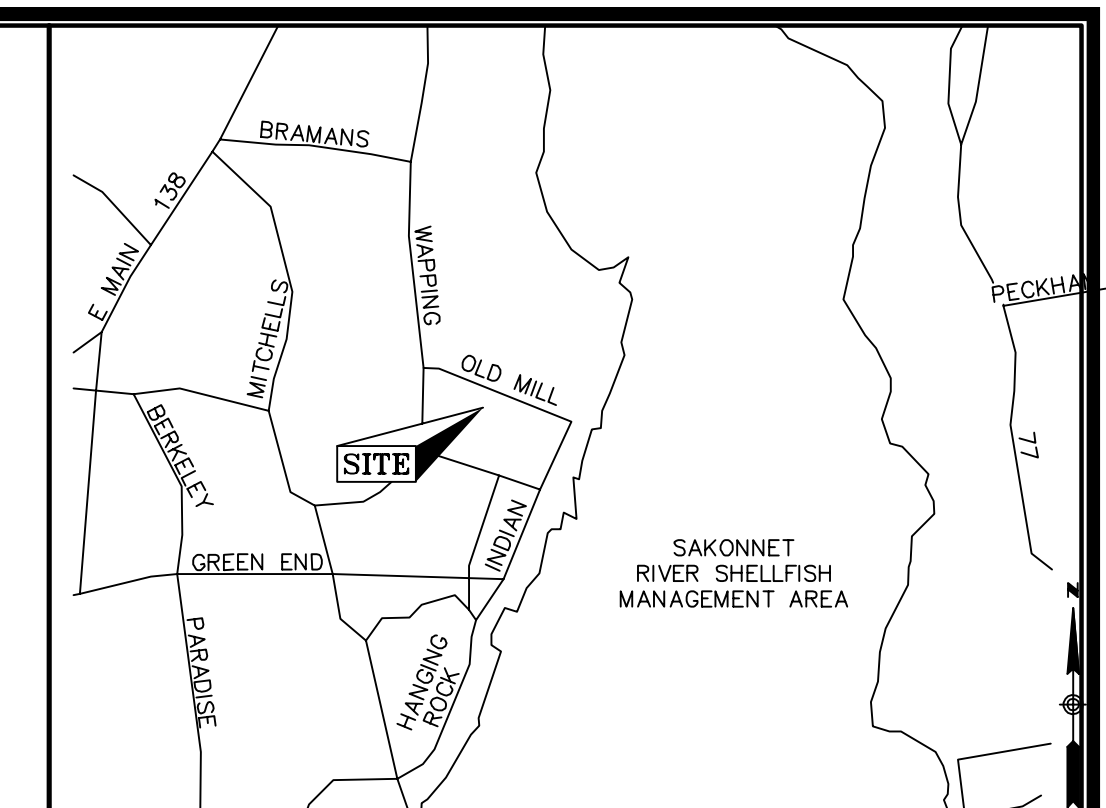

NOTES

1. THIS PLAN WAS PREPARED FROM AN ACTUAL ON THE GROUND FIELD SURVEY CONDUCTED BY WSP IN JULY OF 2021.
2. THE BEARING SYSTEM SHOWN HEREON IS REFERENCED TO THE NORTH AMERICAN DATUM OF 1983, RHODE ISLAND STATE PLANE COORDINATE SYSTEM AND WAS ESTABLISHED UTILIZING RTK GPS SURVEY TECHNIQUES REFERENCING THE SMARTNET GPS NETWORK.
3. THE SURVEYED PROPERTY IS SUBJECT BUT NOT LIMITED TO THE INFORMATION SHOWN HEREON. ALL INFORMATION THAT MAY AFFECT THE QUALITY OF THE TITLE TO BOTH THE SUBJECT AND ADJOINING PARCELS SHOULD BE VERIFIED BY AN ACCURATE AND CURRENT TITLE REPORT. THIS SURVEY WAS PREPARED WITHOUT THE BENEFIT OF A CURRENT TITLE REPORT.

PLAN REFERENCES

1. PLAN ENTITLED "ADMINISTRATIVE SUBDIVISION, MIDDLE CREEK FARM, LLC, A.P. 128 LOT 67 (MIDDLETOWN), A.P. 68, LOT 71-12 (PORTSMOUTH), MIDDLETOWN, RHODE ISLAND," DATED JUNE 29, 2016, PREPARED BY NORTHEAST ENGINEERS & CONSULTANTS, INC. RECORDED IN THE TOWN CLERK'S OFFICE OF MIDDLETOWN, RHODE ISLAND AS PLAN 1644.
2. PLAN ENTITLED "ADMINISTRATIVE SUBDIVISION, OVERALL PLAN, MIDDLE CREEK FARM, LLC, A.P. 128 LOT 67 (MIDDLETOWN), A.P. 68, LOT 71-12 (PORTSMOUTH), MIDDLETOWN, RHODE ISLAND," DATED FEBRUARY 6, 2015, PREPARED BY NORTHEAST ENGINEERS & CONSULTANTS, INC. RECORDED IN THE TOWN CLERK'S OFFICE OF MIDDLETOWN, RHODE ISLAND AS PLAN 2015-1.
3. PLAN ENTITLED "MINOR SUBDIVISION PLAN," DATED DECEMBER 3, 2013, PREPARED BY MOUNT HOPE ENGINEERING, RECORDED IN THE TOWN CLERK'S OFFICE OF MIDDLETOWN, RHODE ISLAND AS PLAN 2014-27.
4. PLAN ENTITLED "PARCELS A, B, & C, LAND OF EDUARDO MEDEIROS SOUTO, ET ALS., MIDDLETOWN, RHODE ISLAND," DATED MARCH 27, 1980, PREPARED BY HAROLD E. ST. JOHN, RECORDED IN THE TOWN CLERK'S OFFICE OF MIDDLETOWN, RHODE ISLAND AS PLAN BOOK 13 MAP 68.
5. PLAN ENTITLED "LAND OF ESTATE JOHN O. BETTENCOURT, OLD MILL LANE, PORTSMOUTH, R.I.," DATED SEPTEMBER 15, 1972, PREPARED BY FRANCIS J. O'LOUGHLIN, RECORDED IN THE TOWN CLERK'S OFFICE OF PORTSMOUTH, RHODE ISLAND.
6. PLAN ENTITLED "LAND OF SEVENTEEN INC., PORTSMOUTH, RHODE ISLAND," DATED JULY 15, 1960, PREPARED BY HAROLD E. ST. JOHN, RECORDED IN THE TOWN CLERK'S OFFICE OF PORTSMOUTH, RHODE ISLAND AS 1-D-2-MAP-2

GRAPHIC SCALE

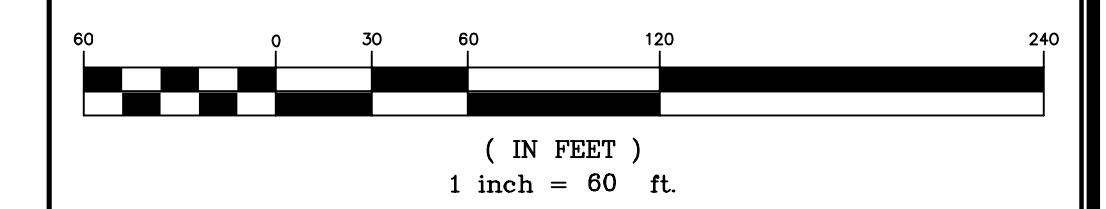

REVISION	DATE	DESCRIPTION

**PLAN OF LAND
 OLD MILL LANE
 PORTSMOUTH, RHODE ISLAND
 PREPARED FOR
 NARRAGANSETT ELECTRIC COMPANY
 d/b/a NATIONAL GRID**

Prepared for:

nationalgrid
 LAND SURVEYING DEPARTMENT
 40 SYLVAN RD.
 WALTHAM, MA 02451

Prepared by:

wsp
 WSP USA, Inc.
 9 Executive Park Dr. Suite 101
 Merrimack, NH 03054
 603-324-0894

Project #	30901161.001	Date	JULY 28, 2021
Work Order #	90000204811	Scale: Drawn:	1"=60'
Drawing	30901161.001-1.dwg	Scale: Plotted:	1"=60'







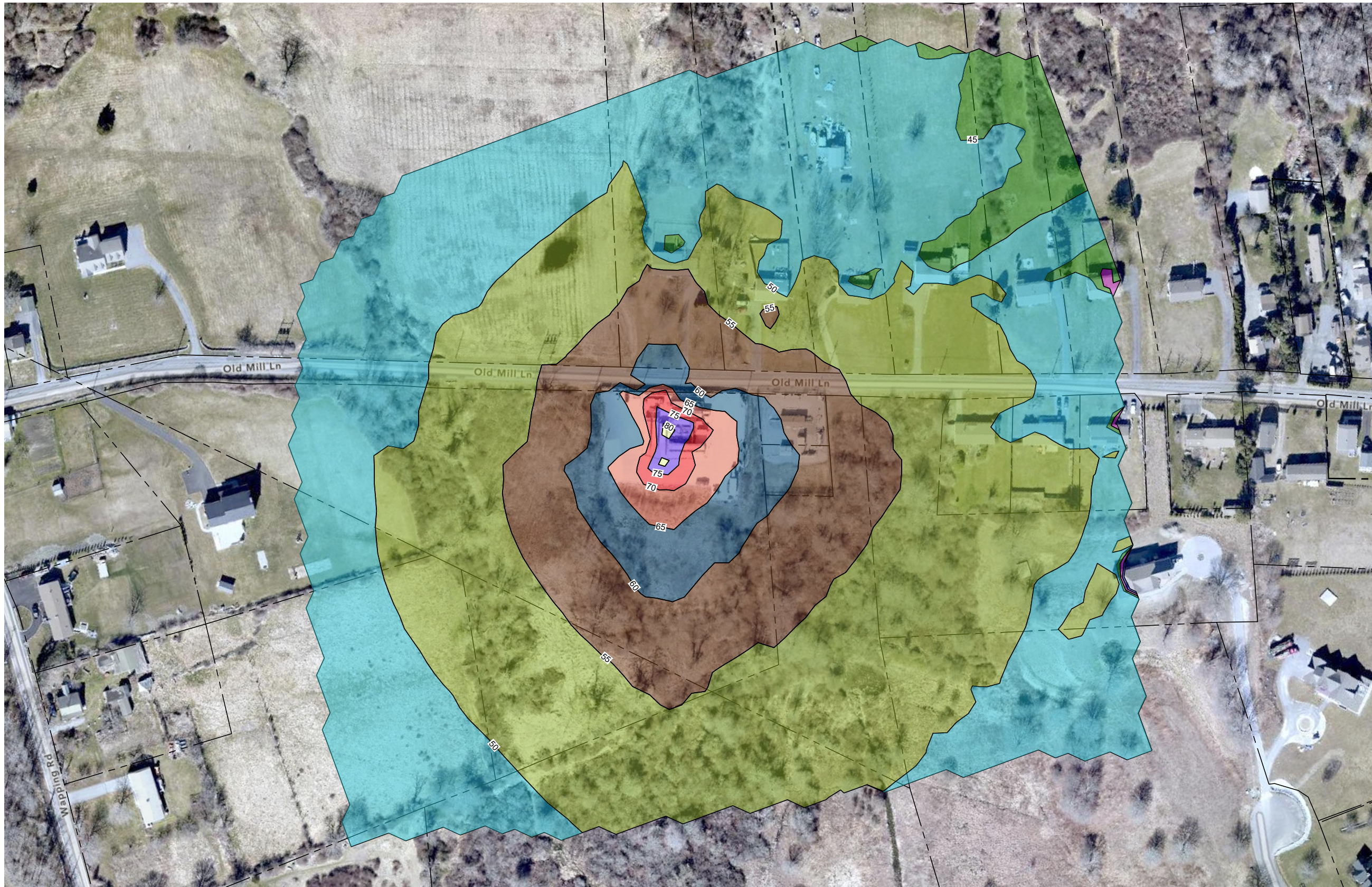



NOTES:

1. AERIAL IMAGE TAKEN FROM RIDEM GIS - RI MAPS & AERIAL PHOTOS AND NOT TO SCALE.
2. PROPERTY LINE LOCATIONS ARE APPROXIMATED BASED ON MUNICIPAL GIS WEBVIEWERS FROM CITY OF PORTSMOUTH, RI GIS AND CITY OF MIDDLETOWN, RI GIS, TOWN OF PORTSMOUTH PLAT MAPS, AND TOWN OF MIDDLETOWN PLAT MAPS.

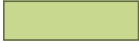

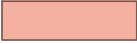
LEGEND

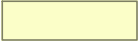
LMAX (dBA)	
	<35
	35-40
	40-45
	45-50
	50-55
	55-60
	60-65
	65-70
	70-75
	75-80
	>80



PROJECT TITLE
AQUIDNECK ISLAND GAS RELIABILITY PROJECT

SHEET TITLE
OPERATIONAL NOISE CONTOURS; EXISTING CASE (Lmax)

SCALE
1" = 150'

PROJECT NUMBER
10328992

PROJECT MANAGER
ANKIT DHAR







DATE
07/26/2023



NOTES:

1. AERIAL IMAGE TAKEN FROM RIDEM GIS - RI MAPS & AERIAL PHOTOS AND NOT TO SCALE.
2. PROPERTY LINE LOCATIONS ARE APPROXIMATED BASED ON MUNICIPAL GIS WEBVIEWERS FROM CITY OF PORTSMOUTH, RI GIS AND CITY OF MIDDLETOWN, RI GIS, TOWN OF PORTSMOUTH PLAT MAPS, AND TOWN OF MIDDLETOWN PLAT MAPS.

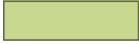
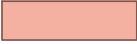
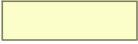
LEGEND

LMAX (dBA)	
	<35
	45-50
	60-65
	75-80
	35-40
	50-55
	65-70
	>80
	40-45
	55-60
	70-75



PROJECT TITLE
AQUIDNECK ISLAND GAS RELIABILITY PROJECT

SHEET TITLE
**500 MSCFH Vaporizer and Pump Trailer Operation-
 Noise Contour Map**

SCALE
1" = 150'

PROJECT NUMBER
10328992

PROJECT MANAGER
ANKIT DHAR



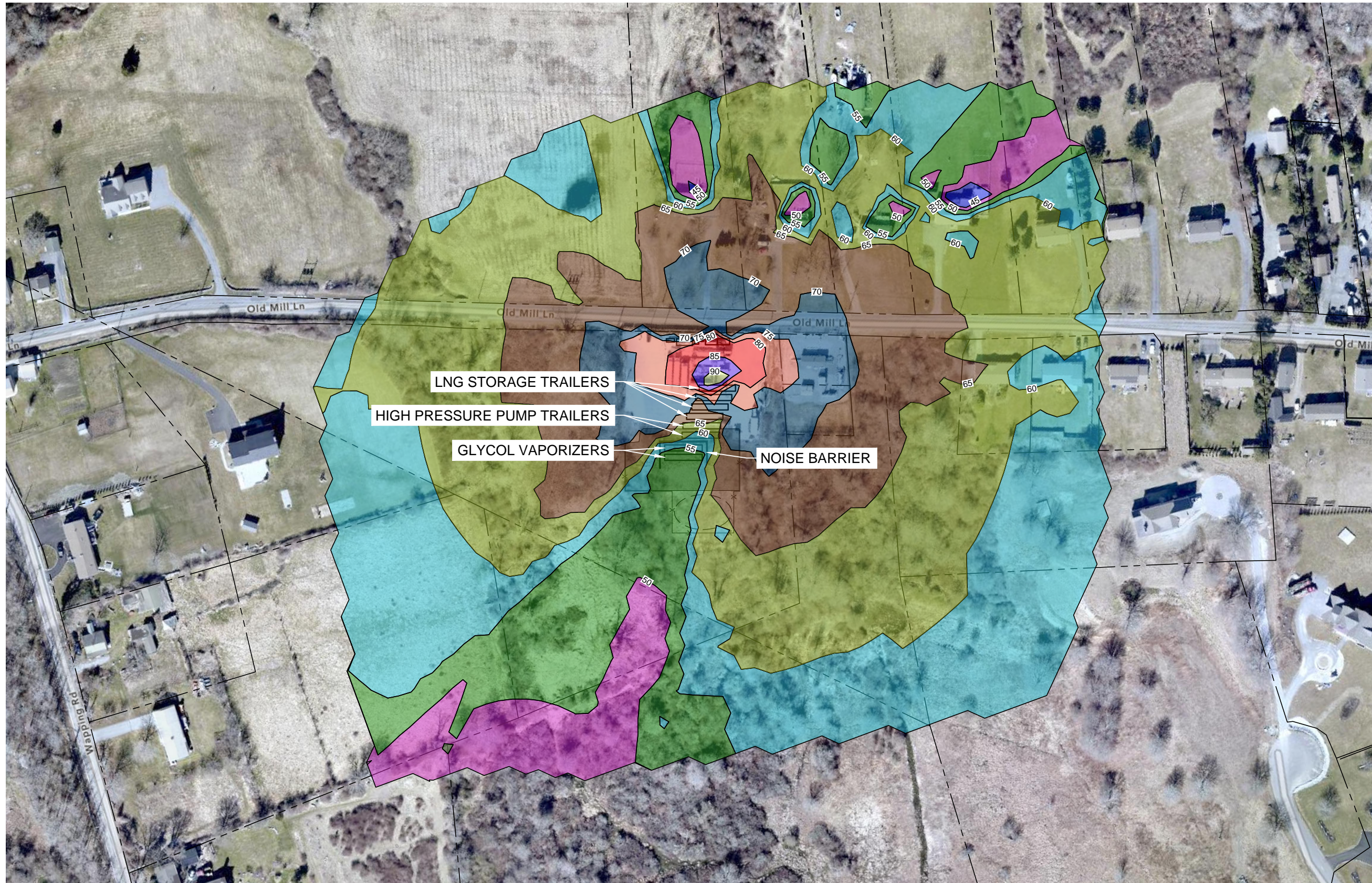





DATE
03/28/2023

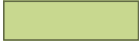

NOTES:

1. AERIAL IMAGE TAKEN FROM RIDEM GIS - RI MAPS & AERIAL PHOTOS AND NOT TO SCALE.
2. PROPERTY LINE LOCATIONS ARE APPROXIMATED BASED ON MUNICIPAL GIS WEBVIEWERS FROM CITY OF PORTSMOUTH, RI GIS AND CITY OF MIDDLETOWN, RI GIS, TOWN OF PORTSMOUTH PLAT MAPS, AND TOWN OF MIDDLETOWN PLAT MAPS.

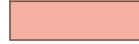
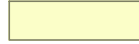
LEGEND

LMAX (dBA)			
	<45		55-60
	45-50		60-65
	50-55		65-70
	70-75		85-90
	75-80		>90
	80-85		



PROJECT TITLE
AQUIDNECK ISLAND GAS RELIABILITY PROJECT

SHEET TITLE
Storage Tank Cooldown - Noise Contour Map

SCALE
1" = 150'

PROJECT NUMBER
10328992

PROJECT MANAGER
ANKIT DHAR

DATE
06/21/2023